



## M82 - M72

POSIZIONAMENTO  
E TENUTA SENZA COLLANTI  
ADJUST NOZZLE POSITION  
AND SEAL WITHOUT BONDING



82.617.18  
82.617.68 FPM / FKM



82.617.19



82.617.20



G1/4M.-1/4" BSPM  
Dado con O Ring  
Nut with O Ring



Kit Ghiera AD/AC  
AD/AC cap kit



72.610.7



72.610.8



72.610.9

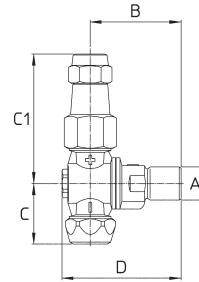
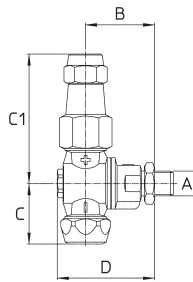
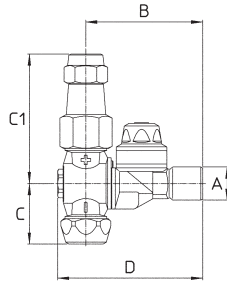
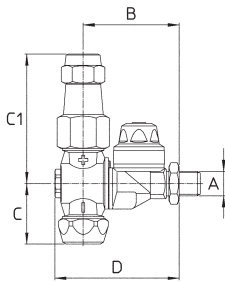

**Standard:** lato regolabile con ghiera Ch20 G3/8F. e ugello AMT Ø15  
lato fisso con ghiera M75 Ø15 75.605.46 o kit ghiera AD / AC per ugelli Kit Ø15, ATR / TVI e AD/AC ALBUZ ®  
versioni con attacco G1/4M.: dado G1/4F. con O Ring NBR  
versioni con attacco G3/8M. - G1/8F.: dado G3/8F.  
versioni 82.617.68 G1/4M. con tenute in FPM  
versione 82.617.18 SU G1/4M. senza ugello nel lato regolabile

Pressione di esercizio max.: 40 bar

Peso: M82: G1/4M. 340 g - G3/8M. 355 g - G1/4F. 340 g  
M72: G1/4M. 275 g - G3/8M. 290 g - G1/4F. 275 g

**Materiali:** ottone - acciaio inox - NBR - PVC - FPM

**Impiego:** su atomizzatori. Il lato regolabile consente il trattamento di colture ad alto fusto. Due ugelli selezionabili con posizioni intermedie di chiusura. Compatibile con ugelli AMT Ø15, ATR / TVI, AD/AC ALBUZ ®. Due posizioni di spruzzo inclinate di 20°. Posizioni segnalate da uno scatto. M82 con antigoccia resistente ed efficace in un ampio range di pressioni. Versioni G1/4M. fornite con dado e O Ring per il montaggio orientato del getto sui collettori senza utilizzare collanti.

**Standard: adjustable side supplied with 3/8" BSPF. hex.20 cap and Ø15 AMT spray tip**  
**fixed spray angle side with M75 Ø15 75.605.46 or AD / AC caps to assemble Ø15 kit, ATR / TVI or AD / AC ALBUZ ® spray tips**

**1/4" BSPM. models: 1/4" BSPF. nut and Buna N O Ring**

**3/8" BSPM. - 1/8" BSPF. models: 3/8" BSPF. nut**

**82.617.68 1/4" BSPM. models with FKM seals**

**82.617.18 SU 1/4" BSPM. model without spray tip on adjustable side**

Max. operating pressure: 40 bar / 580 psi

Weight: M82: G1/4M. 340 g / 12 oz - G3/8M. 355 g / 12.5 oz - G1/4F. 340 g / 12 oz  
M72: G1/4M. 275 g / 9.5 oz - G3/8M. 290 g / 10 oz - G1/4F. 275 g / 9.5 oz

**Materials:** brass - stainless steel - Buna N - PVC - FKM

**Use:** on air blast sprayers. The adjustable side allows spray pattern variation for high trees coverage. Rollover to select spray tips with two shut off positions. Improved spray tip configuration: fits Ø15 AMT, ATR / TVI and AD / AC ALBUZ ® spray tips. Two "OPEN" positions at ±20° from vertical. A click point out each position. M82 models fitted with check valve that assures efficient and long lasting operations in a wide range of pressures. 1/4" BSPM. boom connection models supplied with nut and O Ring to adjust nozzle position on booms without bonding.



M82

COME SI ORDINA / HOW TO ORDER

CODICE code	GHIERA LATO FISSO fixed side cap	FORO UGELLO spray tip hole mm		PER UGELLI for spray tips	A	B mm	C mm	C1 mm	D mm		KIT RICAMBIO spare parts kit
		REGOLABILE adjustable	FISSO fixed								
82.617.18	Ø15	Ø1.5	Ø15 kit ATR/TVI		G1/4M. 1/4" BSPM	51	32	68	66	10	75.302.28
82.617.18 10	Ø15	Ø1.0	Ø15 kit ATR/TVI								
82.617.18 12	Ø15	Ø1.2	Ø15 kit ATR/TVI								
82.617.18 18	Ø15	Ø1.8	Ø15 kit ATR/TVI								
82.617.18 20	Ø15	Ø2.0	Ø15 kit ATR/TVI								
82.617.18 D	AD / AC	Ø1.5	AD/AC								
82.617.18 DA	AD / AC	Ø1.0	AD/AC								
82.617.18 DB	AD / AC	Ø1.2	AD/AC								
82.617.18 DC	AD / AC	Ø1.8	AD/AC								
82.617.18 DD	AD / AC	Ø2.0	AD/AC								
82.617.18 SU	Ø15	-	Ø15 kit ATR/TVI								
82.617.68	Ø15	Ø1.5	Ø15 kit ATR/TVI		G1/4M. 1/4" BSPM	51	32	68	66	10	90.302.59
82.617.68 10	Ø15	Ø1.0	Ø15 kit ATR/TVI								
82.617.68 12	Ø15	Ø1.2	Ø15 kit ATR/TVI								
82.617.68 18	Ø15	Ø1.8	Ø15 kit ATR/TVI								
82.617.68 20	Ø15	Ø2.0	Ø15 kit ATR/TVI								
82.617.68 D	AD / AC	Ø1.5	AD/AC								
82.617.68 DA	AD / AC	Ø1.0	AD/AC								
82.617.68 DB	AD / AC	Ø1.2	AD/AC								
82.617.68 DC	AD / AC	Ø1.8	AD/AC								
82.617.68 DD	AD / AC	Ø2.0	AD/AC								
82.617.19	Ø15	Ø1.5	Ø15 kit ATR/TVI		G3/8M. G1/8F. 3/8" BSPM. 1/8" BSPF.	51	32	68	66	10	75.302.28
82.617.19 10	Ø15	Ø1.0	Ø15 kit ATR/TVI								
82.617.19 12	Ø15	Ø1.2	Ø15 kit ATR/TVI								
82.617.19 18	Ø15	Ø1.8	Ø15 kit ATR/TVI								
82.617.19 20	Ø15	Ø2.0	Ø15 kit ATR/TVI								
82.617.19 D	AD / AC	Ø1.5	AD/AC								
82.617.19 DA	AD / AC	Ø1.0	AD/AC								
82.617.19 DB	AD / AC	Ø1.2	AD/AC								
82.617.19 DC	AD / AC	Ø1.8	AD/AC								
82.617.19 DD	AD / AC	Ø2.0	AD/AC								
82.617.20	Ø15	Ø1.5	Ø15 kit ATR/TVI		G1/4F. 1/4" BSPF.	62	32	68	77	10	75.302.28
82.617.20 10	Ø15	Ø1.0	Ø15 kit ATR/TVI								
82.617.20 12	Ø15	Ø1.2	Ø15 kit ATR/TVI								
82.617.20 18	Ø15	Ø1.8	Ø15 kit ATR/TVI								
82.617.20 20	Ø15	Ø2.0	Ø15 kit ATR/TVI								
82.617.20 D	AD / AC	Ø1.5	AD/AC								
82.617.20 DA	AD / AC	Ø1.0	AD/AC								
82.617.20 DB	AD / AC	Ø1.2	AD/AC								
82.617.20 DC	AD / AC	Ø1.8	AD/AC								
82.617.20 DD	AD / AC	Ø2.0	AD/AC								

FPM / FKM

M72

COME SI ORDINA / HOW TO ORDER

CODICE code	GHIERA LATO FISSO fixed side cap	FORO UGELLO spray tip hole mm		PER UGELLI for spray tips	A	B mm	C mm	C1 mm	D mm		KIT RICAMBIO spare parts kit
		REGOLABILE adjustable	FISSO fixed								
72.610.7	Ø15	Ø1.5	Ø15 kit ATR/TVI		G1/4M. 1/4" BSPM	37	32	68	52	10	70.302.27
72.610.7 10	Ø15	Ø1.0	Ø15 kit ATR/TVI								
72.610.7 12	Ø15	Ø1.2	Ø15 kit ATR/TVI								
72.610.7 18	Ø15	Ø1.8	Ø15 kit ATR/TVI								
72.610.7 20	Ø15	Ø2.0	Ø15 kit ATR/TVI								
72.610.8	Ø15	Ø1.5	Ø15 kit ATR/TVI		G3/8M. G1/8F. 3/8" BSPM. 1/8" BSPF.	37	32	68	52	10	70.302.27
72.610.8 10	Ø15	Ø1.0	Ø15 kit ATR/TVI								
72.610.8 12	Ø15	Ø1.2	Ø15 kit ATR/TVI								
72.610.8 18	Ø15	Ø1.8	Ø15 kit ATR/TVI								
72.610.8 20	Ø15	Ø2.0	Ø15 kit ATR/TVI								
72.610.9	Ø15	Ø1.5	Ø15 kit ATR/TVI		G1/4F. 1/4" BSPF.	48	32	68	63	10	70.302.27
72.610.9 10	Ø15	Ø1.0	Ø15 kit ATR/TVI								
72.610.9 12	Ø15	Ø1.2	Ø15 kit ATR/TVI								
72.610.9 18	Ø15	Ø1.8	Ø15 kit ATR/TVI								
72.610.9 20	Ø15	Ø2.0	Ø15 kit ATR/TVI								



UGELLI  
TIPS