

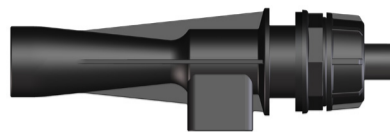

MISCELATORI / MIXERS

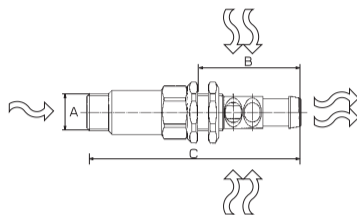

163.1.2



163.1004.5 ÷ 8
ANTI SCHIUMA - ANTI-FOAM

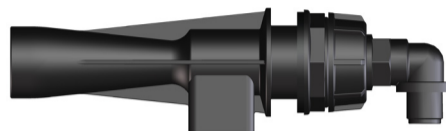

163.1004.9 ÷ 12
ANTI SCHIUMA - ANTI-FOAM



IDRAULICO

163.1.2: Standard completo di filtro, dadi e guarnizioni

163.1004.5: Standard con ghiera e guarnizione

163.1004.9: Standard con ghiera e guarnizione

Pressione di esercizio max.: 30 bar

Peso: 163.1.2 250 g - 163.1004.5 140 g - 163.1004.9 160 g

Materiali: ottone - acciaio inox - allumina - NBR - materiali plastici ad alta resistenza

Impiego: su gruppi irroranti e diserbanti. Miscelatori ad alte prestazioni. 163.1.2 con filtro. 163.1004.5÷8 e 163.1004.9÷12 anti schiuma. Ugelli ispezionabili.

HYDRAULIC

163.1.2: Standard with strainer, nuts and gaskets

163.1004.5: Standard with nuts and gasket

163.1004.9: Standard with nuts and gasket

Max operating pressure: 30 bar / 435 psi

Weight: 163.1.2 250 g / 8.8oz - 163.1004.5 140 g / 4.9 oz -

163.1004.9 160 g / 5.6 oz

Materials: brass - stainless steel - alumina - Buna N - high resistance plastic materials

Use: on boom and air blast sprayers. High efficiency mixers with double Venturi. 163.1.2 with strainer. 163.1004.5÷8 and 163.1004.9÷12 anti-foam. Easy maintenance spray tips.

COME SI ORDINA / HOW TO ORDER

CODICE code	FORO UGELLO mm tip Ø mm	A	B	C	
163.1.2	1.5 ceramica - ceramic	G1/2M. - 1/2"BSPM.	60	125	10
163.1.2 12	1.2 ceramica - ceramic				
163.1.2 18	1.8 ceramica - ceramic				
163.1.2 20	2.0 ceramica - ceramic				
163.1.2 23	2.3 ceramica - ceramic				
163.1.2 40	HEX. 4				
163.1004.5	1.2 ceramica - ceramic	G1/2M. - 1/2"BSPM. G1 1/4M. - 1 1/4"BSPM.	165	220	5
163.1004.6	1.5 ceramica - ceramic				
163.1004.7	2.0 ceramica - ceramic				
163.1004.8	3.0 ceramica - ceramic				
163.1004.9	1.2 ceramica - ceramic	G1/2M. - 1/2"BSPM. G1 1/4M. - 1 1/4"BSPM.	165	255	5
163.1004.10	1.5 ceramica - ceramic				
163.1004.11	2.0 ceramica - ceramic				
163.1004.12	3.0 ceramica - ceramic				

FORO UGELLO TIP HOLE mm	PORTATA UGELLO l/min - TIP FLOWRATE USGal/min					PER CISTERNE - LITRI FOR TANKS - USGallons
	PRESSIONE bar / PRESSURE psi					
	10 / 150	15 / 220	20 / 300	25 / 360	30 / 450	
Ø1.2	2.2 - 0.6	2.7 - 0.7	3.1 - 0.8	3.5 - 0.9	3.8 - 1.0	100 - 200 / 26 - 53
Ø1.5	3.6 - 0.9	4.4 - 1.1	5.1 - 1.3	5.7 - 1.5	6.2 - 1.6	210 - 360 / 55 - 95
Ø1.8	5.0 - 1.3	6.1 - 1.6	7.1 - 1.9	7.9 - 2.1	8.7 - 2.3	370 - 520 / 97 - 135
Ø2.0	5.8 - 1.5	7.1 - 1.9	8.2 - 2.2	9.2 - 2.4	10.0 - 2.6	530 - 700 / 140 - 185
Ø2.3	8.0 - 2.1	9.8 - 2.6	11.3 - 3.0	12.7 - 3.4	13.9 - 3.7	710 - 1000 / 187 - 264
Ø3.0	13.1 - 3.5	16.0 - 4.2	18.5 - 4.9	20.7 - 5.5	22.7 - 6.0	1010 - 1300 / 267 - 343



COMANDI
CONTROL UNITS



GIUNTI
HOSE SHANKS



CATALOGHI
CATALOGUES



RICAMBI
SPARE PARTS :

163.1.2