

VARIANTE E
E MODEL

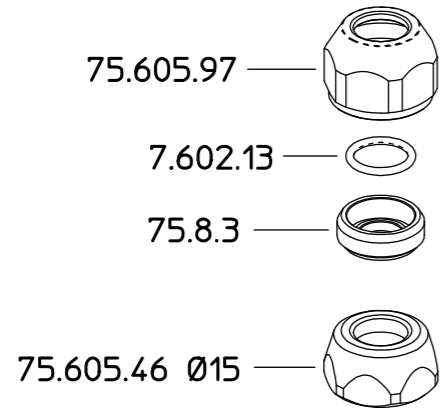

VARIANTE D
D MODEL

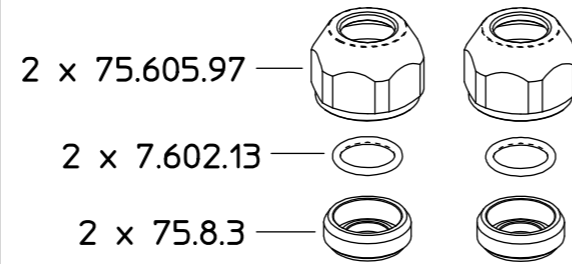

VARIANTE STANDARD
STANDARD MODEL

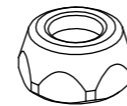

75.605.61 —

266.1003.15 —

75.1310.12 —

300.1006.3 —

75.1007.8 —

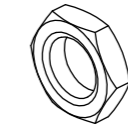

75.301.23

Thread sealant
LOXEAL 56-03

75.1902.24
3-4 Nm

73.507.1
35-40 cNm

73.209.1 —

73.602.22 —

73.602.22 —

65.1314.38 —

65.112.5 —

73.507.1
35-40 cNm

75.602.40 —

65.229.2 —

75.1003.23 —

75.507.9 —

65.1617.64 —

65.111.17

65.627.5
65.627.5 D
65.627.5 E

SOLO PER KIT
FOR KIT ONLY



23.602.34 X2

68.602.10

73.602.22 X3

260.602.14 X2

VARIANTE STANDARD
STANDARD MODEL



COME SI ORDINA/HOW TO ORDER
Kit ricambio
Spare parts kit **75.302.28**

DESCRIZIONE: GETTO M65 G3/8M. G1/8F. Ø15

N°revisione
09 Data revisione
15/05/2019

Braglia SRL Tel. +39 0522 340648
Fax. +39 0522 345025
I-42122 REGGIO EMILIA - ITALY - UE Email tecnico@braglia.it

DISEGNATO
M.CORRADINI APPROVATO
G.BRAGLIA

Dis.N°/Codice
65.627.5