

180.620.9

MONTAGGIO VITE 180.1902.58 E RONDELLA 180.1506.42
ESEGUIRE LAVORAZIONE SUL GRUPPO MOTORIDUTTORE MONTATO
DISEGNO 180.620.9

180.1305.11
ARANCIO/ORANGE

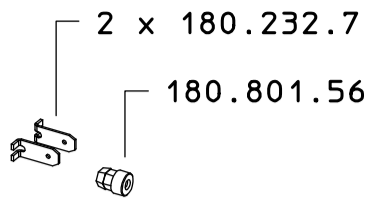
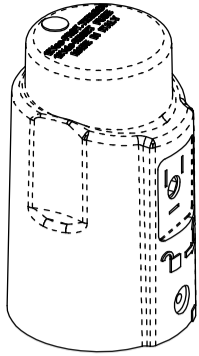

180.1305.22
ARANCIO/ORANGE

180.510.2

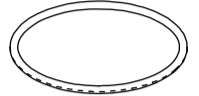

142.602.18

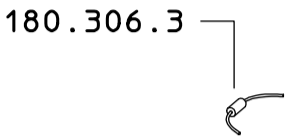

180.1011.3

180.806.1

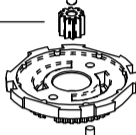

180.1605.9

2 x 180.1902.39

4 x 180.806.5



4 x 180.1512.1

180.806.7



4 x 180.806.5



4 x 180.1512.1

180.806.7



4 x 180.806.5



4 x 180.1512.1

180.806.7



4 x 180.806.6



4 x 180.1512.1

180.806.7



180.806.11

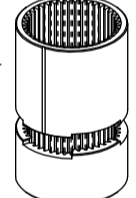

180.806.13

4 x 180.806.6



4 x 180.1512.1

180.223.1
90°



180.1506.22



4 x 300.1902.23

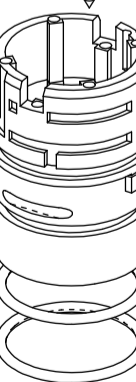
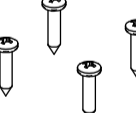

180.214.13

180.602.49

180.602.49



180.4.10

180.1506.27

2 x 180.1009.1

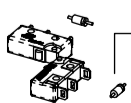

2 x 180.306.1

4 x 180.1902.25

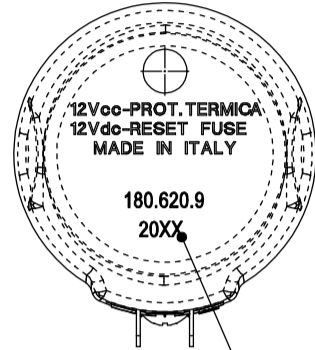
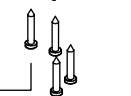

MARCATURA LASER
Scala 1:1

NOTE DI MONTAGGIO

- Cablaggio non rappresentato
- Utilizzare grasso LBT2 nei piani di riduzione
- Utilizzare il disegno 180.620.9 per il cablaggio

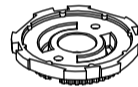

180.1605.9

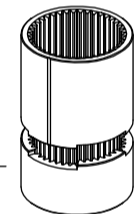

180.806.11

180.806.13

POSIZIONE MONTAGGIO CORONE

180.1617.27
1.8/90°

DESCRIZIONE: GRUPPO MOTORID. EP35 18/90° ARANCIO		N°revisione 08	Data revisione 26/02/2013
	Tel. +39 0522 340648	DISEGNATO	APPROVATO
	Fax. +39 0522 345025	M.CORRADINI	G.BRAGLIA
I-42122 REGGIO EMILIA - ITALY - UE Email tecnico@braglia.it		Dis.N°/Codice 180.620.9	