

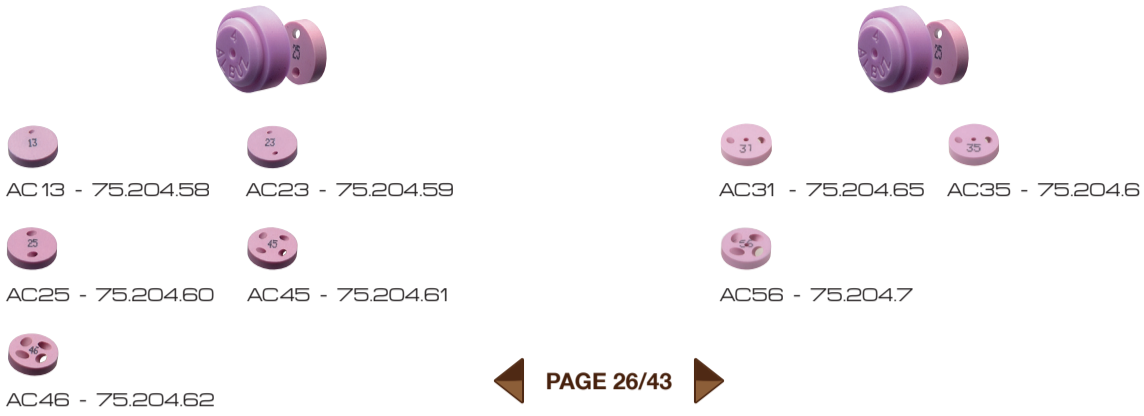

ALBUZ® UGELLO AD - CONVOGLIATORE AC AD DISC - AC CORE

ALBUZ
ITALIAN
EXCLUSIVE
DISTRIBUTOR



PAGE 26/43

CONO VUOTO / HOLLOW CONE

CONO PIENO / FULL CONE

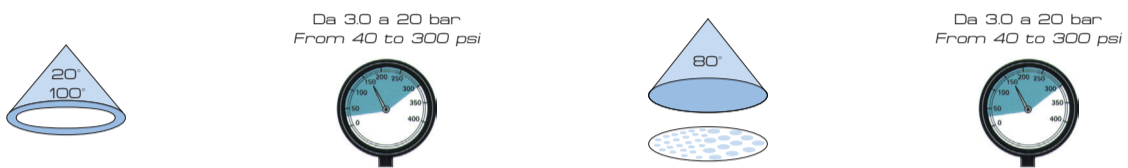

73.508.9
filtro a fessura PA66
PA66 slotted strainer

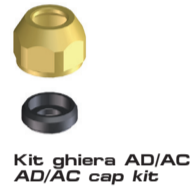
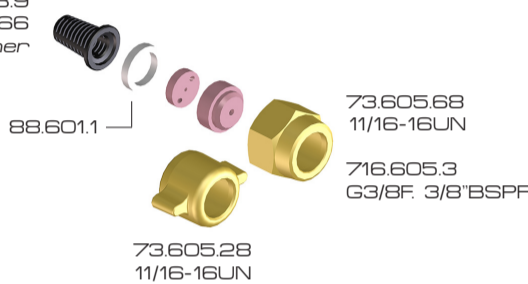

Coppia di serraggio max. 5 Nm
Max. torque 5 Nm / 3.7 lb ft

Materiali: allumina.

Impiego: trattamenti fungicidi e insetticidi su atomizzatori. Raccomandati per arboricoltura e vigneti. Dimensione delle gocce fine. Le combinazioni Ugello AD e Convoigliatore AC consentono di ottenere un'ampia gamma di portate e di angoli di spruzzo. Impiego ad alta pressione senza decadimento della qualità dello spruzzo. Pressione consigliata 10 bar.

Confezioni da: 50

Materials: alumina.

Use: fungicide and insecticide spraying on air blast sprayers. Recommended for orchards and vineyards. Fine droplets. Disc and core combinations allow a wide choice of flow rates and spray angles. Good performances and high spraying quality even at high pressure. 10 bar (150psi) recommended operating pressure.

Pieces per box: 50

UGELLI AD + CONVOGLIATORI AC (cono vuoto) AD DISCS + AC CORES (hollow cone)										UGELLI AD + CONVOGLIATORI AC (cono pieno) AD DISCS + AC CORES (full cone)													
COME SI ORDINA HOW TO ORDER	FORO HOLE mm	PORTATA l/min (±10%) FLOW RATE l/min (±10%)						ANGOLO ANGLE		COME SI ORDINA HOW TO ORDER	FORO HOLE mm	PORTATA l/min (±10%) FLOW RATE l/min (±10%)						ANGOLO ANGLE					
		3 bar	4 bar	5 bar	6 bar	10 bar	15 bar	20 bar	10 bar			20 bar	3 bar	4 bar	5 bar	6 bar	10 bar	15 bar	20 bar	10 bar	20 bar		
AD1 75.1804.7	AC13 75.204.58	0.80	0.24	0.27	0.30	0.33	0.41	0.49	0.56	70°	79°	AD1 75.1804.7	AC31 75.204.65	0.80	0.53	0.61	0.67	0.73	0.92	1.10	1.25	39°	39°
AD2 75.1804.8		1.02	0.31	0.35	0.39	0.42	0.53	0.64	0.73	87°	97°	AD2 75.1804.8		1.02	0.82	0.93	1.03	1.12	1.41	1.69	1.92	87°	97°
AD3 75.1804.9		1.20	0.36	0.41	0.45	0.49	0.61	0.74	0.84	89°	98°	AD3 75.1804.9		1.20	0.87	0.99	1.10	1.19	1.50	1.80	2.05	65°	62°
AD4 75.1804.10		1.56	0.45	0.52	0.57	0.62	0.78	0.93	1.06	99°	103°	AD4 75.1804.10		1.56	0.80	0.92	1.03	1.12	1.41	1.69	1.92	34°	40°
AD1 75.1804.7	AC23 75.204.59	0.80	0.28	0.32	0.35	0.38	0.48	0.57	0.65	66°	74°	AD1 75.1804.7	AC35 75.204.6	0.80	0.92	1.05	1.16	1.26	1.58	1.90	2.16	39°	39°
AD2 75.1804.8		1.02	0.37	0.43	0.47	0.51	0.64	0.77	0.88	83°	93°	AD2 75.1804.8		1.02	0.92	1.05	1.16	1.26	1.58	1.90	2.16	39°	39°
AD3 75.1804.9		1.20	0.44	0.51	0.56	0.61	0.76	0.92	1.04	84°	92°	AD3 75.1804.9		1.20	1.28	1.46	1.61	1.75	2.20	2.64	3.00	44°	42°
AD4 75.1804.10		1.56	0.56	0.64	0.71	0.77	0.97	1.16	1.32	92°	98°	AD4 75.1804.10		1.56	2.08	2.37	2.62	2.84	3.58	4.30	4.89	77°	72°
AD5 75.1804.11		2.00	0.72	0.82	0.91	0.99	1.24	1.49	1.70	96°	95°	AD5 75.1804.11		2.00	2.62	2.98	3.30	3.58	4.51	5.41	6.16	37°	34°
AD6 75.1804.12	2.40	0.85	0.97	1.07	1.16	1.46	1.75	2.00	99°	101°	AD6 75.1804.12	2.40	2.62	2.98	3.30	3.58	4.51	5.41	6.16	37°	34°		
AD1 75.1804.7	AC25 75.204.60	0.80	0.41	0.46	0.51	0.55	0.70	0.84	0.95	50°	60°	AD2 75.1804.8	AC56 75.204.7	0.80	0.88	1.00	1.11	1.20	1.52	1.82	2.10	21°	20°
AD2 75.1804.8		1.02	0.59	0.67	0.74	0.80	1.01	1.21	1.38	57°	66°	AD3 75.1804.9		1.02	1.19	1.36	1.50	1.63	2.05	2.46	2.80	28°	32°
AD3 75.1804.9		1.20	0.72	0.81	0.90	0.98	1.23	1.46	1.68	63°	69°	AD4 75.1804.10		1.20	1.56	1.78	1.97	2.18	2.78	3.37	4.17	35°	38°
AD4 75.1804.10		1.56	1.02	1.16	1.28	1.39	1.75	2.10	2.39	75°	80°	AD5 75.1804.11		1.56	2.05	2.33	2.58	2.8	3.52	4.23	4.81	35°	38°
AD5 75.1804.11		2.00	1.41	1.60	1.77	1.92	2.42	2.90	3.30	77°	80°	AD6 75.1804.12		2.00	3.46	3.94	4.36	4.73	5.96	7.15	8.14	43°	40°
AD6 75.1804.12		2.40	1.73	1.97	2.18	2.37	2.98	3.57	4.07	82°	85°	AD7 75.1804.13		2.40	5.11	5.82	6.43	6.98	8.78	10.54	12.0	56°	49°
AD7 75.1804.13		2.80	2.07	2.36	2.61	2.83	3.57	4.28	4.87	86°	91°	AD7 75.1804.13		2.80	6.87	7.81	8.64	9.38	11.8	14.17	16.12	68°	64°
AD1 75.1804.7	AC26 75.204.61	0.80	0.48	0.55	0.61	0.68	0.83	1.00	1.14	32°	39°	AD1 75.1804.7	AC56 75.204.7	0.80	0.55	0.62	0.69	0.75	0.94	1.13	1.29	23°	27°
AD2 75.1804.8		1.02	0.73	0.83	0.92	1.00	1.26	1.51	1.72	46°	53°	AD2 75.1804.8		1.02	0.92	1.05	1.16	1.26	1.58	1.90	2.16	26°	30°
AD3 75.1804.9		1.20	0.92	1.05	1.16	1.26	1.58	1.90	2.16	48°	52°	AD3 75.1804.9		1.20	1.20	1.37	1.51	1.64	2.06	2.48	2.82	30°	30°
AD4 75.1804.10		1.56	1.35	1.54	1.70	1.85	2.32	2.79	3.17	73°	72°	AD4 75.1804.10		1.56	2.03	2.32	2.56	2.78	3.50	4.20	4.78	35°	35°
AD5 75.1804.11		2.00	1.78	2.05	2.31	2.51	3.20	3.91	4.54	59°	60°	AD5 75.1804.11		2.00	3.11	3.54	3.91	4.24	5.34	6.41	7.30	40°	42°
AD6 75.1804.12		2.40	2.46	2.79	3.09	3.35	4.22	5.07	5.77	72°	75°	AD6 75.1804.12		2.40	4.12	4.69	5.18	5.62	7.08	8.49	9.67	49°	47°
AD7 75.1804.13		2.80	3.01	3.43	3.79	4.11	5.18	6.21	7.07	79°	80°	AD7 75.1804.13		2.80	5.49	6.40	7.10	7.84	10.16	12.43	14.33	55°	53°