

82.617.5
 82.617.5 10
 82.617.5 12
 82.617.5 18
 82.617.5 20
 82.617.5 D
 82.617.5 DA
 82.617.5 DB
 82.617.5 DC
 82.617.5 DD

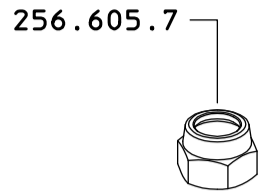

VARIANTE STANDARD / VARIANTE D
 STANDARD MODEL / D MODEL

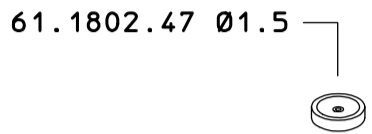

VARIANTE STANDARD / STANDARD MODEL
 PER TUTTE LE VARIANTI / FOR ALL MODELS

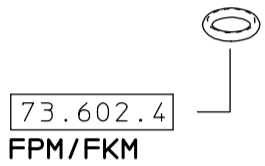

VARIANTI
 MODELS

- 10 e DA - 61.1802.45 Ø1.0
- 12 e DB - 61.1802.46 Ø1.2
- 18 e DC - 61.1802.48 Ø1.8
- 20 e DD - 61.1802.55 Ø2.0

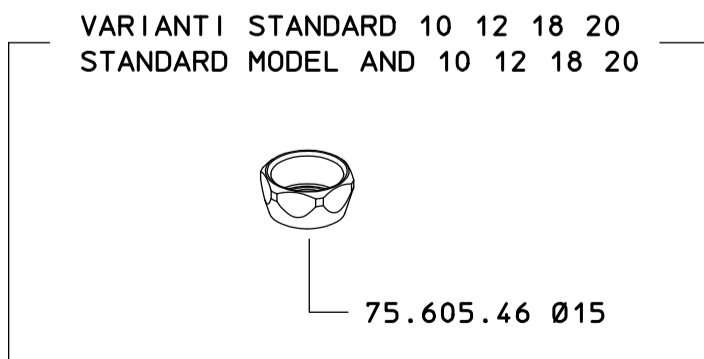
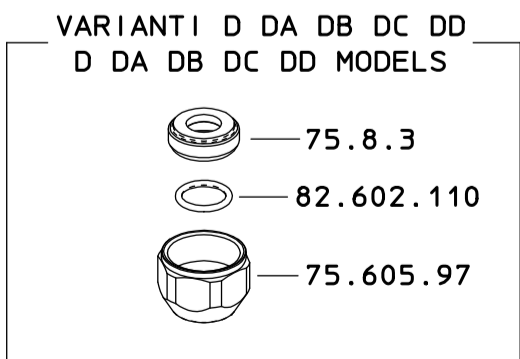
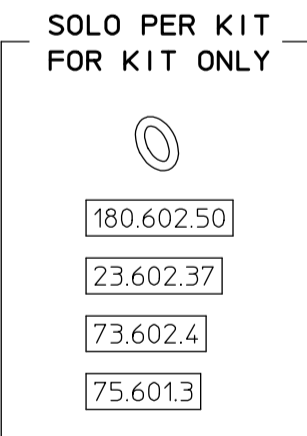
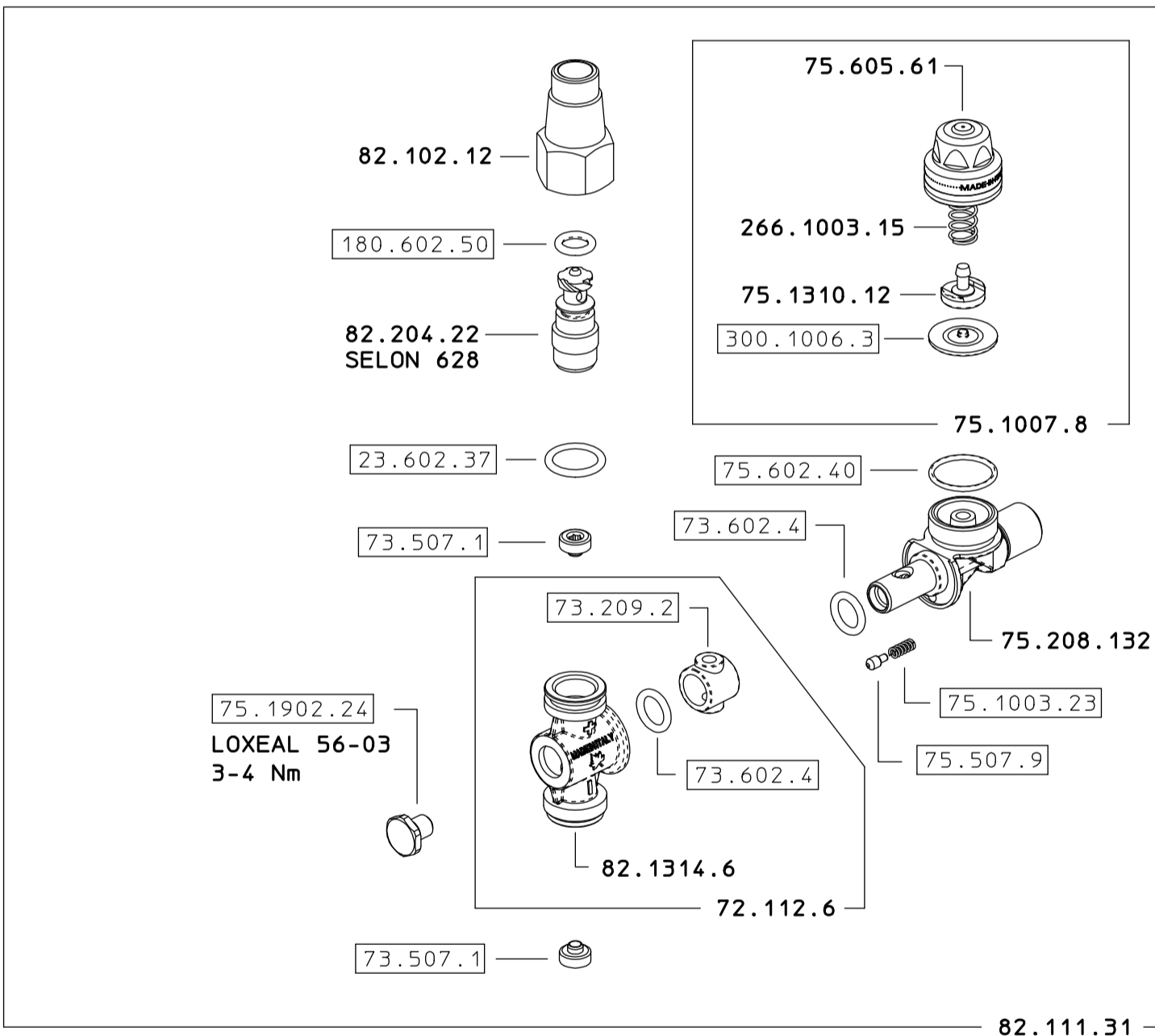

COME SI ORDINA / HOW TO ORDER
 Kit ricambio
 Spare parts kit **90.302.59**