

**76.617.31**  
**76.617.31 D**  
**76.617.31 15**

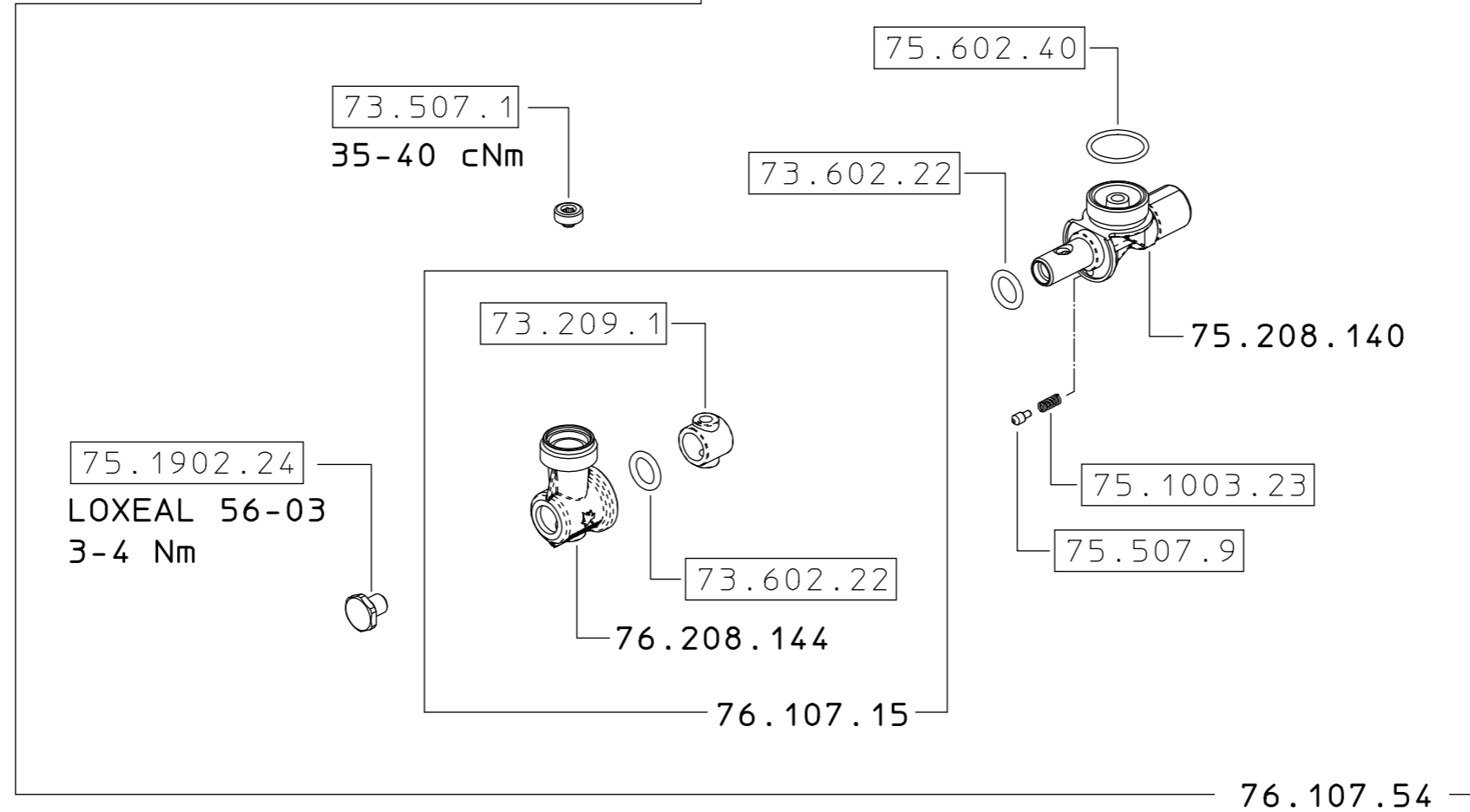
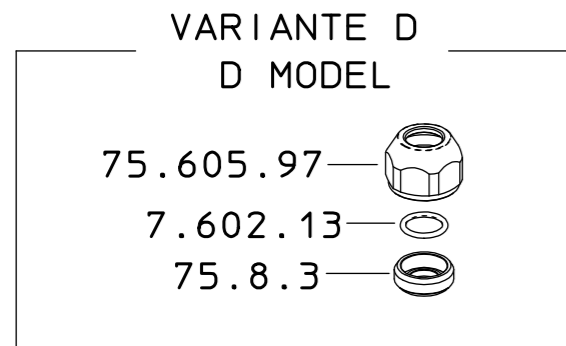
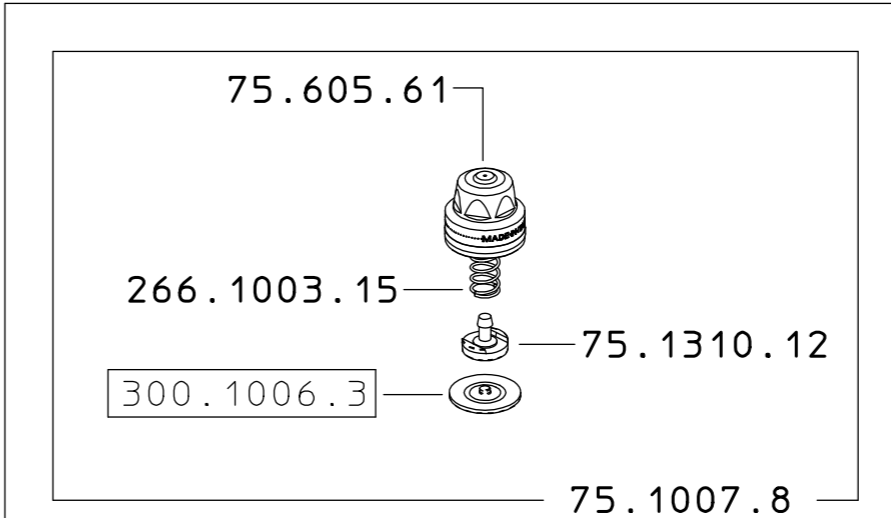
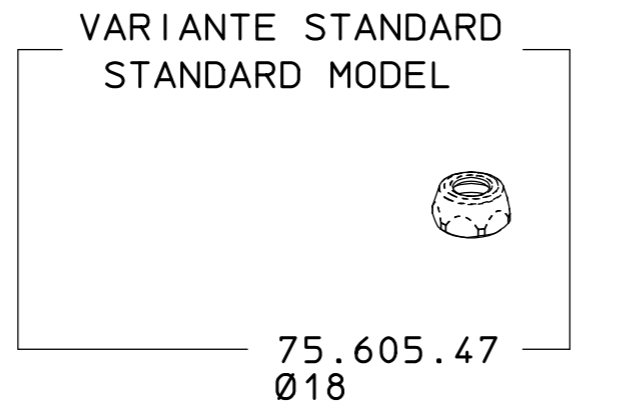
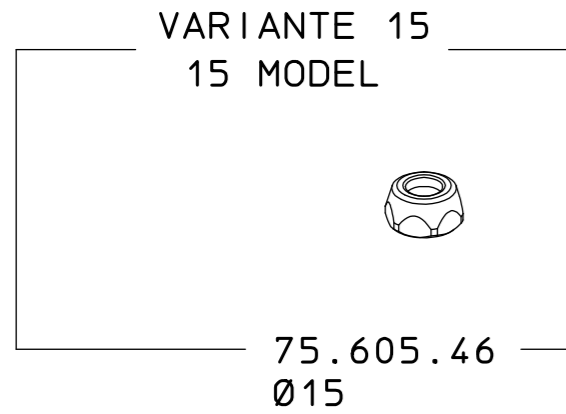

- SOLO PER KIT  
FOR KIT ONLY
- 23.602.34 x 2
  - 68.602.10
  - 73.602.22 x 3
  - 260.602.14 x 2
  - 73.507.1

COME SI ORDINA/HOW TO ORDER  
 Kit ricambio **75.302.28**  
 Spare parts kit

|   |                               |                               |                                     |
|---|-------------------------------|-------------------------------|-------------------------------------|
| DESCRIZIONE: <b>GETTO M76 Ø18 G1/4F.</b>  |                               | N°revisione<br><b>04</b>      | Data revisione<br><b>31/03/2020</b> |
| <b>Braglia</b> SRL<br>Tel. +39 0522 340648<br>Fax. +39 0522 345025<br>I-42122 REGGIO EMILIA - ITALY - UE Email tecnico@braglia.it | DISEGNATO<br><b>G.BRAGLIA</b> | APPROVATO<br><b>G.BRAGLIA</b> | Dis.N°/Codice<br><b>76.617.31</b>   |