

N°3 x 200.1902.3
0.8/1.2 Nm

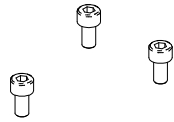

203.1903.28

203.1903.28AA

VARIANTE STANDARD
STANDARD MODEL

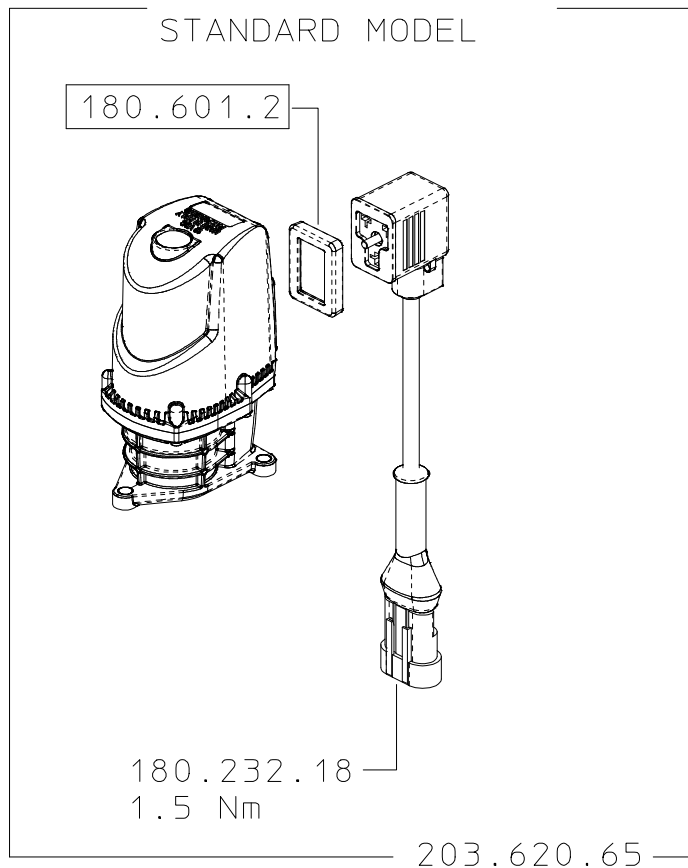

VARIANTE AA
AA MODEL

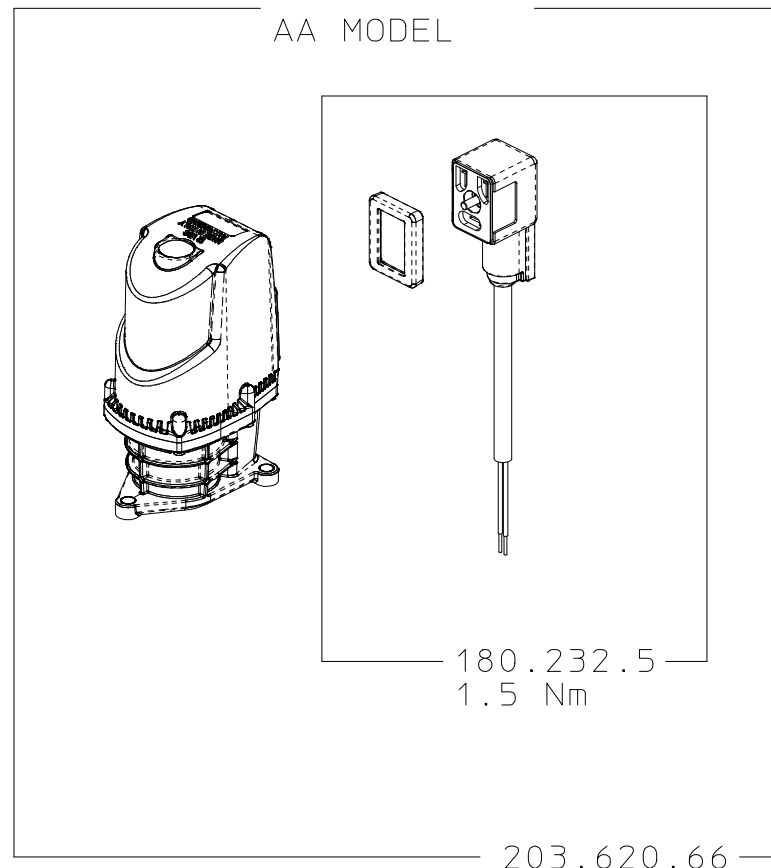

22.602.32

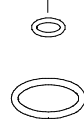

180.602.30

203.4.16



203.1902.62
ATTENZIONE-CRITICO
Grasso MOLY LT2



603.1604.34



203.1310.16

200.602.71



203.614.20



300.1006.3

203.620.64
15 Nm

ATTENZIONE IMPORTANTE
Assemblare in
posizione intermedia

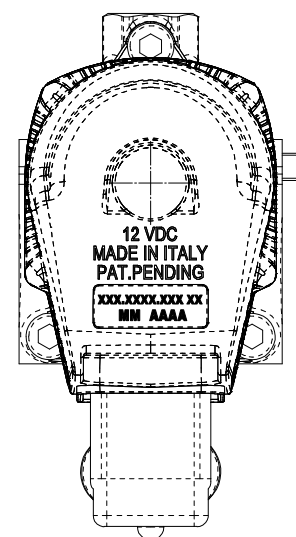

MARCATURA LASER VALVOLA COLLAUDATA
TRUMPF TRUMARK 203.1903.28/203.1903.28AA
Scala 1:1

166.1902.46

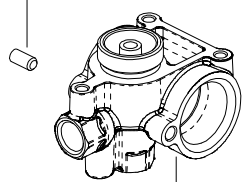

75.602.40

203.218.154

COME SI ORDINA / HOW TO ORDER

Kit ricambio

Spare parts kit

203.302.112

DESCRIZIONE: VALVOLA M203 3 FILI

N°revisione 01
Data revisione 22/01/2020

Braglia SRL
I-42122 REGGIO EMILIA - ITALY - UE
Tel. +39 0522 340648
Fax. +39 0522 345025
Email tecnico@braglia.it

DISEGNATO M.CORRADINI
APPROVATO G.BRAGLIA

Dis.N°/Codice
203.1903.28