



BY PASS 40 BAR / 580 PSI

**GARANZIA 2 ANNI CON VALVOLA M400 MONTATA
2 YEARS WARRANTY WITH ASSEMBLED M400 VALVE**



180.1910.1

180.1910.24

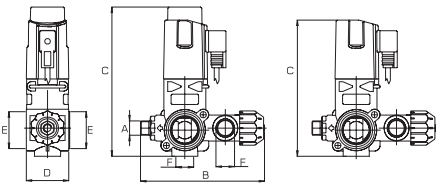
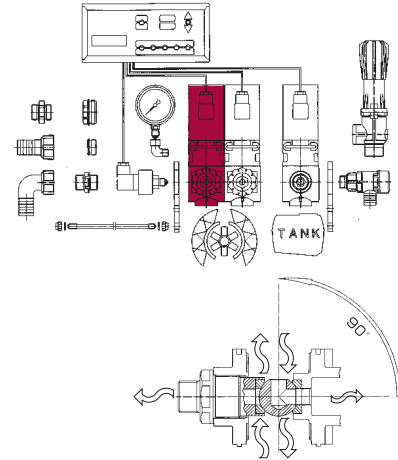

Standard complete di connettore DIN43650 - B con cavo 1.5m costampato (IP67) e O Ring 3187 FPM

Versioni: 180.1910.1 On/Off 1.5 s
180.1910.24 On/Off 0.3 s

Pressione di esercizio max.: 40bar

Peso: 180.1910.1 1.5 kg - 180.1910.24 1.4 kg

Materiali: acciaio inox - materiali plastici ad alta resistenza - FPM - PTFE caricato grafite - ottone con trattamento nichel chimico.

Impiego: su atomizzatori e gruppi irroranti. Valvola a sfera motorizzata, modulare, con microinterruttori di fine corsa. 180.1910.24: On/Off in 0.3s per impieghi che richiedono tempi di intervento rapidi. By-pass regolabile con posizioni a scatto numerate. Tenute in FPM e PTFE caricato grafite. Eccellente affidabilità e durata.

Standard with 1.5m moulded cable DIN 43650 - B connector (IP67), O Ring 3187 FKM

Models: 180.1910.1 On/Off 1.5 s
180.1910.24 On/Off 0.3 s

Max. operating pressure: 40 bar / 580 psi

Weight: 180.1910.1 1.5 kg / 3.3 lb - 180.1910.24 1.4 kg / 3.1 lb

Materials: stainless steel - high resistance plastic materials - FKM - graphitized PTFE - Niploy processed brass.

Use: on air-blast sprayers. Modular electric ball valve. Limit stop micro switches. 180.1910.24 model: 0.3s On/Off quick operation. Constant pressure by-pass adjustable by graduated knob. FKM and graphitized PTFE seals. Long life and reliable.

CARATTERISTICHE TECNICHE / TECHNICAL FEATURES - 180.1910.1

bar psi	l/min-1 bar USG pm-15psi	12Vdc	A	B mm	C mm	D mm	E	F	On/Off	°C
40 580	60 16	0.3 - 0.7A	G1/2M. 1/2" BSPM.	180	215	62	G1 1/4F. 1 1/4" BSPF.	G3/4F. 3/4" BSPF.	1s-1.5s	-10°C - +50°C -14°F - +122°F

CARATTERISTICHE TECNICHE / TECHNICAL FEATURES - 180.1910.24

bar psi	l/min-1 bar USG pm-15psi	12Vdc	A	B mm	C mm	D mm	E	F	On/Off	°C
40 580	60 16	0.3 - 0.7A	G1/2M. 1/2" BSPM.	180	200	62	G1 1/4F. 1 1/4" BSPF.	G3/4F. 3/4" BSPF.	0.3s	-10°C - +50°C -14°F - +122°F

COME SI ORDINA / HOW TO ORDER

CODICE
code

180.1910.1
180.1910.24

VERSIONE
model

BY PASS G1/2M. - 1/2" BSPM.
BY PASS G1/2M. - 1/2" BSPM. (0.3s)

KIT RICAMBIO
spare parts kit

180.302.31
180.302.31



PAGE 193



PAGE 178 - 179



PAGE 180