

18.901.163

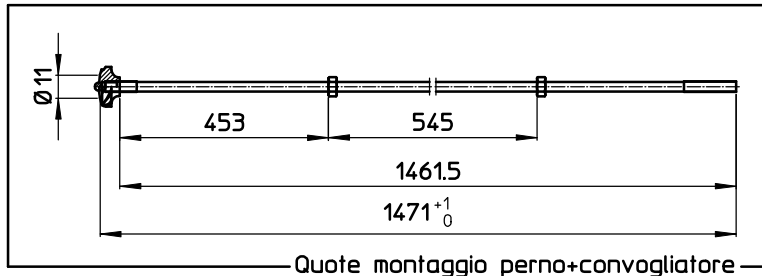

Solo per kit
Only for kit

9.602.11

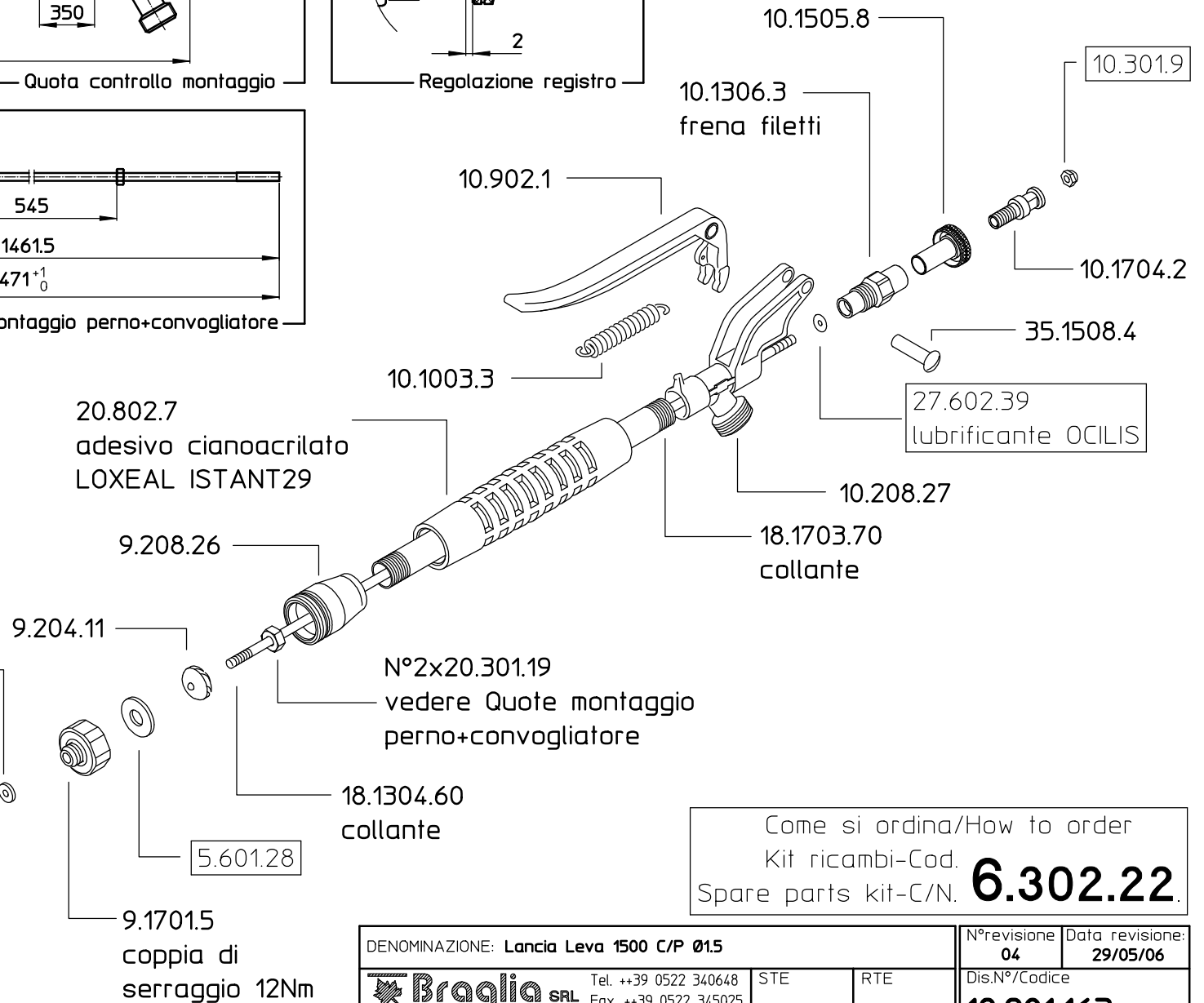
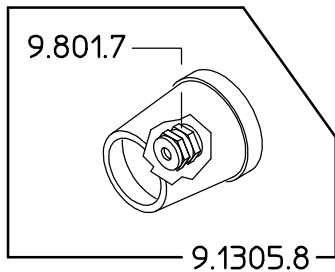

Come si ordina/How to order
Kit ricambi-Cod. **6.302.22**
Spare parts kit-C/N.

DENOMINAZIONE: Lancia Leva 1500 C/P Ø15				N°revisione 04	Data revisione: 29/05/06
	Tel. ++39 0522 340648	STE	RTE	Dis.N°/Codice	
	Fax. ++39 0522 345025			18.901.163	
I-42029 Masone (REGGIO EMILIA)-ITALY-UE Email braglia@braglia.it					