

170.206.23 NU

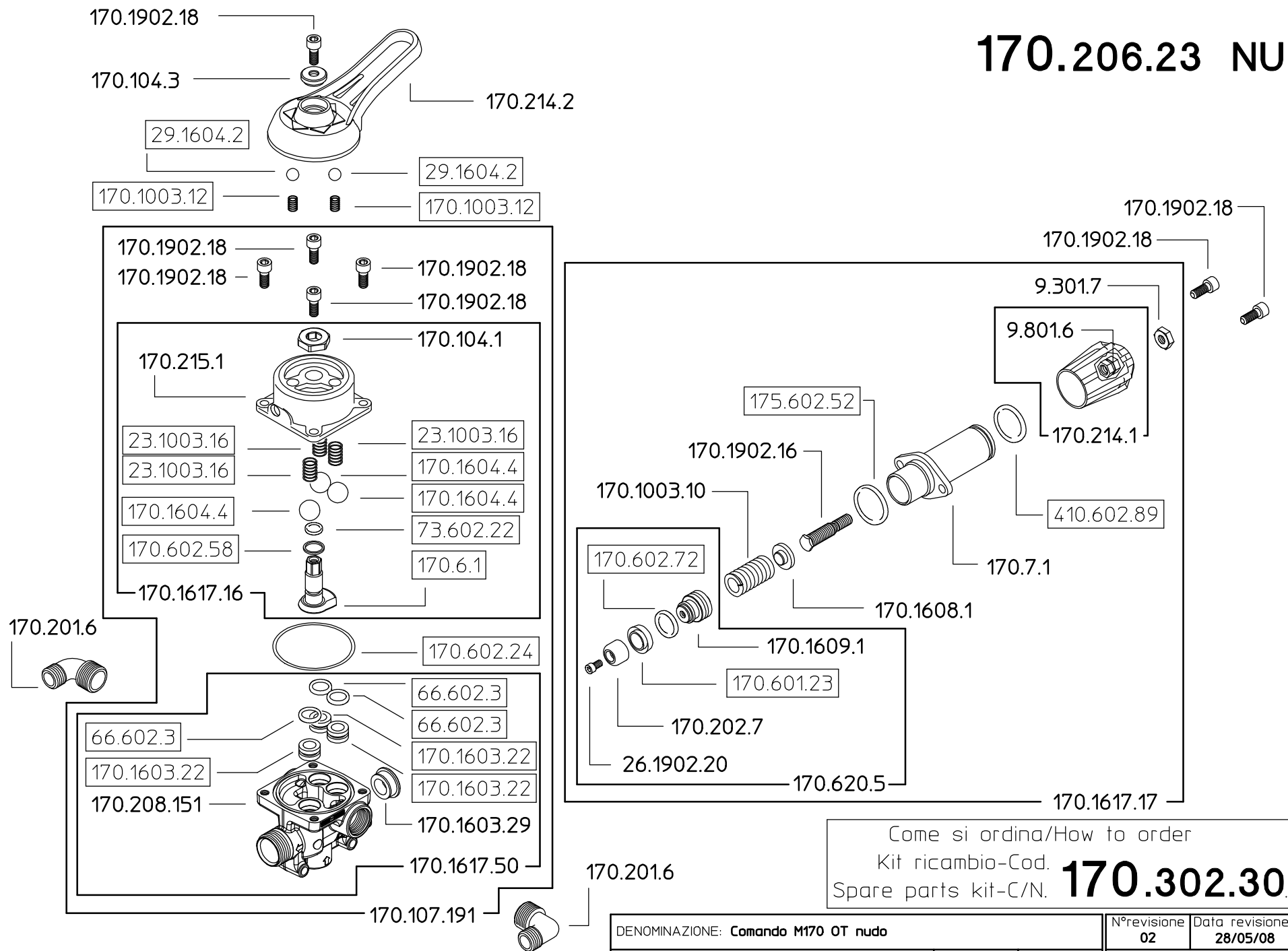

Come si ordina/How to order
Kit ricambio-Cod. **170.302.30**
Spare parts kit-C/N.

DENOMINAZIONE: Comando M170 OT nudo				N°revisione 02	Data revisione: 28/05/08
	Tel. ++39 0522 340648	STE	RTE	Dis.N°/Codice	
	Fax. ++39 0522 345025			170.206.23 NU	
I-42029 Masone (REGGIO EMILIA)-ITALY-UE Email braglia@braglia.it					