

83.1007.5

83.1904.3

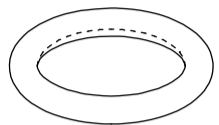

83.602.81

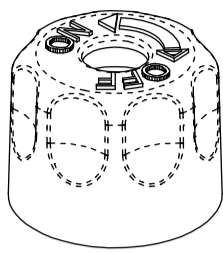
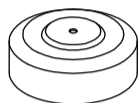
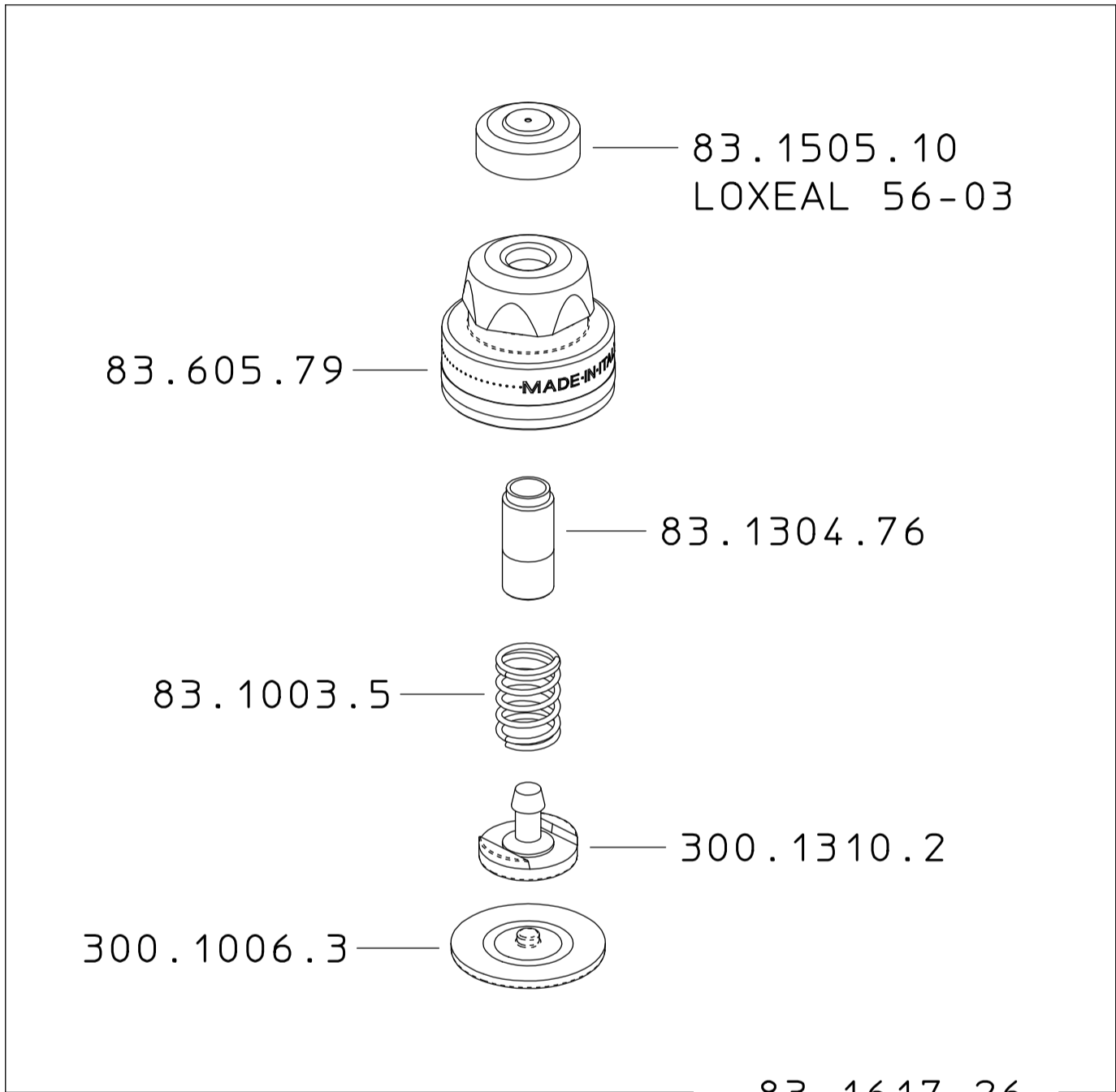

83.1505.10
LOXEAL 56-03

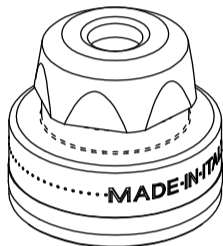

83.605.79

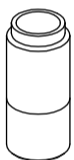

83.1304.76

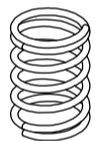

83.1003.5

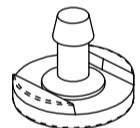

300.1310.2

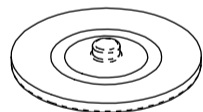

300.1006.3

83.1617.26

Lubrificare con Moly LT2
M8x1 del 83.1304.76

75.602.40

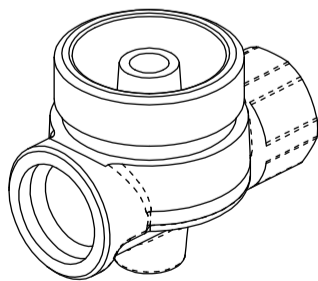
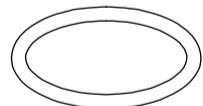

80.208.110

DESCRIZIONE: MODULO M83 G1/4F. G1/4F. CON VOLANTINO

N°revisione
06

Data revisione
23/04/2014

Braglia SRL
I-42122 REGGIO EMILIA - ITALY - UE
Tel. +39 0522 340648
Fax. +39 0522 345025
Email tecnico@braglia.it

DISEGNATO
G.BRAGLIA

APPROVATO
G.BRAGLIA

Dis.N°/Codice

83.1007.5