

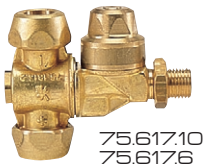

# M75 Ø18 - Ø15

POSIZIONAMENTO  
E TENUTA SENZA COLLANTI  
ADJUST NOZZLE POSITION  
AND SEAL WITHOUT BONDING



75.617.10  
75.617.6

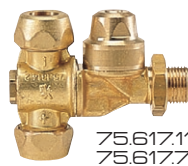

75.617.11  
75.617.7



75.617.12  
75.617.8

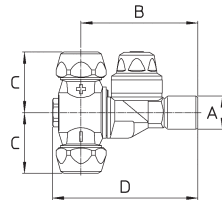
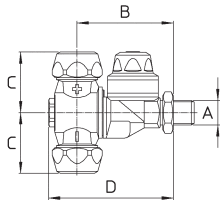

G1/4M-1/4\"/>



Kit ghiera AD/AC  
AD/AC cap kit

**Standard completo di ghiera - ugelli non compresi**

Pressione di esercizio max.: 40 bar

Peso: G1/4M. 255 g - G1/4F. 255 g - G3/8M. 270 g

**Materiali:** ottone - acciaio inox - NBR - FPM - PVC

**Impiego:** su atomizzatori. Due ugelli selezionabili con posizioni intermedie di chiusura. Ingombri ridotti.

Due posizioni "APERTO" inclinate ±15° dalla verticale. Ogni posizione è segnalata da uno scatto. Antigoccia resistente ed efficace a bassa e ad alta pressione.

**Standard with caps - spray tips not included**

Max. operating pressure.: 40 bar / 600 psi

Weight: 1/4\"/>

**Materials:** brass - stainless steel - Buna N - FKM - PVC

**Use:** on air blast sprayers. Very compact. rollover to select spray tips with two shut off positions. Two "OPEN" positions at ±15° from vertical. A click point out each position. Check valve assures efficient and long lasting operations at low and high pressures.

## COME SI ORDINA / HOW TO ORDER

CODICE code	GHIERA cap	PER UGELLI for spray tips	A	B mm	C mm	D mm		KIT RICAMBIO spare parts kit
75.617.10	2xØ18	Ø18 KIT	G1/4M. 1/4\"/>					
75.617.10 A	1xØ18-1xØ15	Ø18 KIT-ATR/TVI						
75.617.10 B	2xØ15	ATR/TVI						
75.617.10 D	2xAD/AC	AD/AC						
75.617.10 E	1xAD/AC-1xØ18	AD/AC-Ø18 KIT						
75.617.10 F	1xAD/AC-1xØ15	AD/AC-ATR/TVI						
75.617.11	2xØ18	Ø18 KIT	G3/8M.-G1/8F. 3/8\"/>					
75.617.11 A	1xØ18-1xØ15	Ø18 KIT-ATR/TVI						
75.617.11 B	2xØ15	ATR/TVI						
75.617.11 D	2xAD/AC	AD/AC						
75.617.11 E	1xAD/AC-1xØ18	AD/AC-Ø18 KIT						
75.617.11 F	1xAD/AC-1xØ15	AD/AC-ATR/TVI						
75.617.12	2xØ18	Ø18 KIT	G1/4F. 1/4\"/>					
75.617.12 A	1xØ18-1xØ15	Ø18 KIT-ATR/TVI						
75.617.12 B	2xØ15	ATR/TVI						
75.617.12 D	2xAD/AC	AD/AC						
75.617.12 E	1xAD/AC-1xØ18	AD/AC-Ø18 KIT						
75.617.12 F	1xAD/AC-1xØ15	AD/AC-ATR/TVI						
75.617.6	2xØ15	Ø15 KIT-ATR/TVI	G1/4M. 1/4\"/>					
75.617.6 D	2xAD/AC	AD/AC						
75.617.6 E	1xAD/AC-1xØ15	AD/AC-Ø15 KIT-ATR/TVI						
75.617.7	2xØ15	Ø15 KIT-ATR/TVI	G3/8M.-G1/8F. 3/8\"/>					
75.617.7 D	2xAD/AC	AD/AC						
75.617.7 E	1xAD/AC-1xØ15	AD/AC-Ø15 KIT-ATR/TVI						
75.617.8	2xØ15	Ø15 KIT-ATR/TVI	G1/4F. 1/4\"/>					
75.617.8 D	2xAD/AC	AD/AC						
75.617.8 E	1xAD/AC-1xØ15	AD/AC-Ø15 KIT-ATR/TVI						

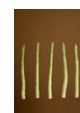

UGELLI  
TIPS