

166.1514.4

VEDERE DISEGNO ESPLOSO 166.1514.1
 FORNITO NON ASSEMBLATO SU 166.107.164
 IMPIEGARE COLLANTE ANAEROBICO SIGILLANTE
 PER FILETTATURE

SEE EXPLODED DRAWING 166.1514.1
 SUPPLIED UNASSEMBLED ON 166.107.164
 USE ANAEROBIC THREADS SEALING ADHESIVE

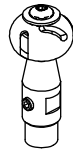

166.1514.1

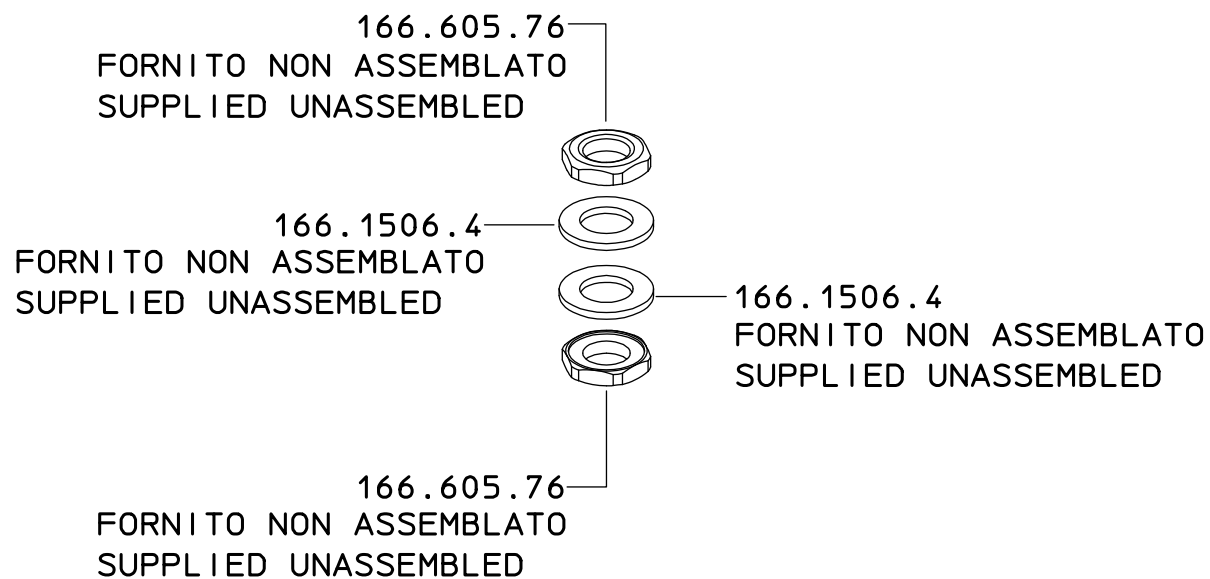
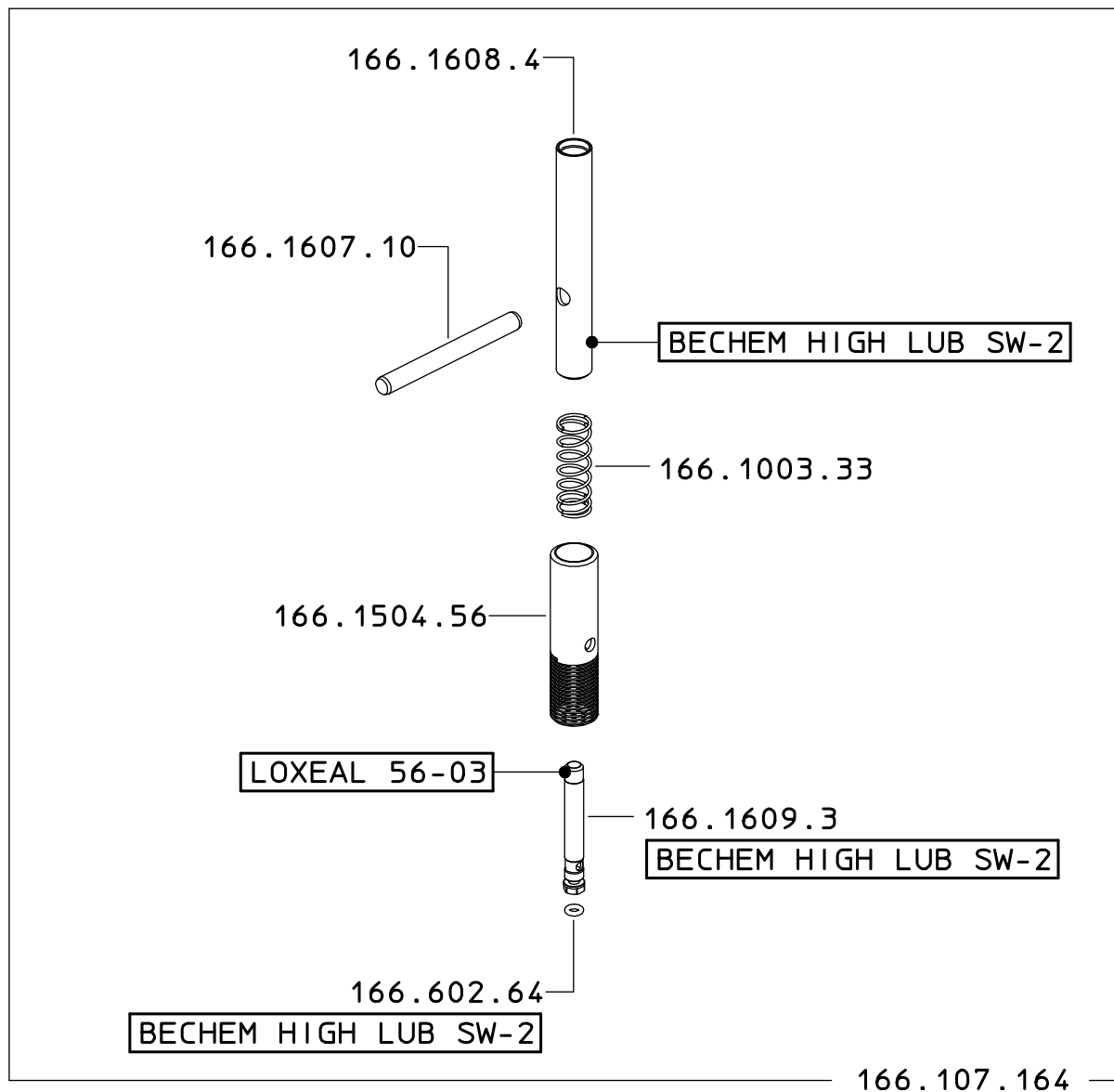

AL TERMINE DELL'IRRORAZIONE ESEGUIRE SEMPRE UN CICLO
 DI LAVAGGIO PER 15/20s UTILIZZANDO ACQUA PULITA

AT THE END OF THE SPRAYING JOB ALWAYS RUN A WASHING
 CYCLE LASTING 15/20s USING CLEAN WATER

DESCRIZIONE: ROLLEX 360° + VALVOLA G1/2M.		N°revisione	Data revisione
		00	12/02/2024
Tel. +39 0522 340648 Fax. +39 0522 345025 I-42122 REGGIO EMILIA - ITALY - UE Email tecnico@braglia.it	DISEGNATO	APPROVATO	
	A.BRAGLIA	G.BRAGLIA	Dis.N°/Codice
			166.1514.4