

83.1007.17

83.1007.17 GH

83.1904.3

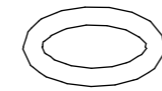

83.602.81

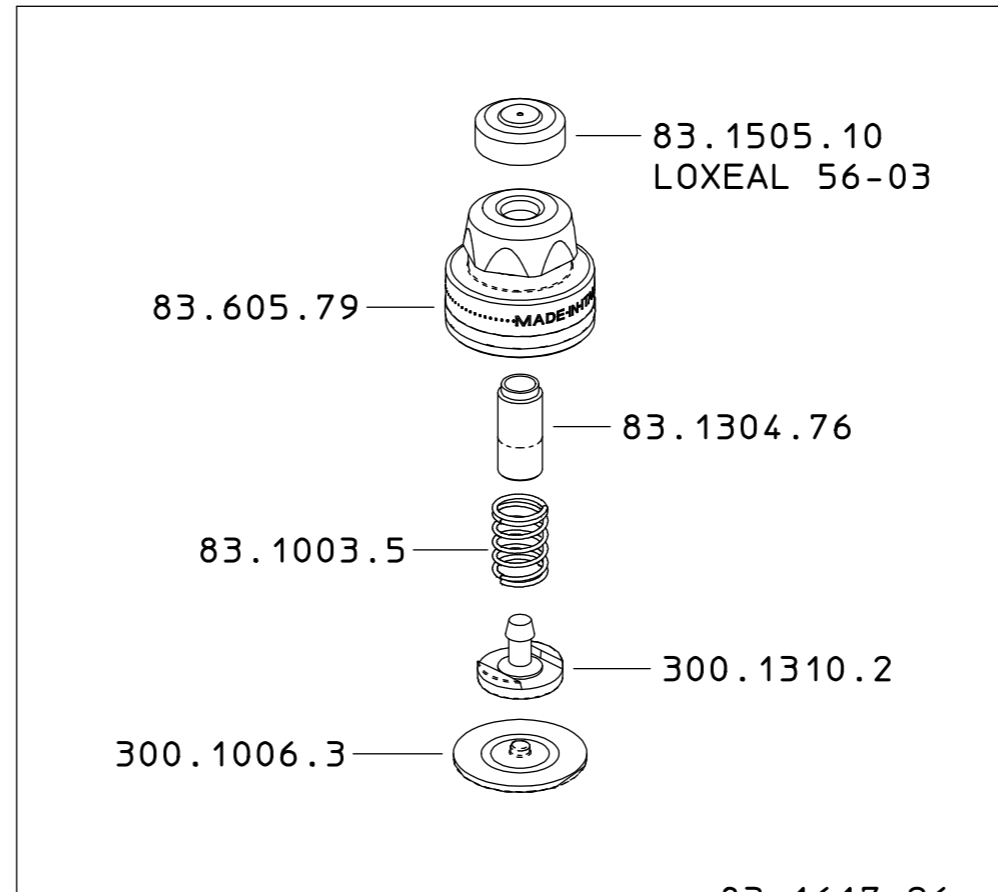

83.1617.26
Lubrificare con Moly LT2
M8x1 del 83.1304.76

VARIANTE GH
GH OPTION

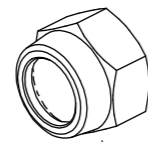

256.605.7

VARIANTE STANDARD
STANDARD OPTION

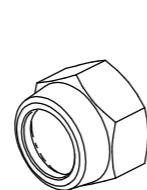

716.605.3

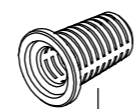

73.508.9

75.602.40

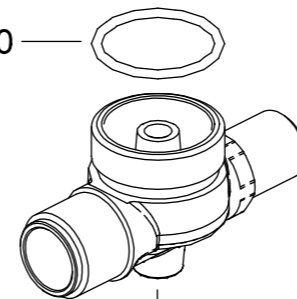

273.208.148

DESCRIZIONE: MODULO M83 G1/4M. C/VOLANTINO+GHIERA

N°revisione 04 Data revisione 12/12/2014

Braglia SRL
Tel. +39 0522 340648
Fax. +39 0522 345025
I-42122 REGGIO EMILIA - ITALY - UE Email tecnico@braglia.it

DISEGNATO
A.BRAGLIA

APPROVATO
G.BRAGLIA

Dis.N°/Codice
83.1007.17