



# TRE VIE / THREE WAYS

**GARANZIA 2 ANNI CON VALVOLA M400 MONTATA  
2 YEARS WARRANTY WITH ASSEMBLED M400 VALVE**



180.1910.7



180.1910.8

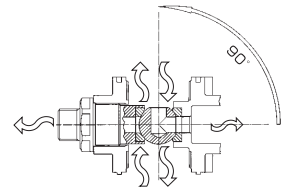
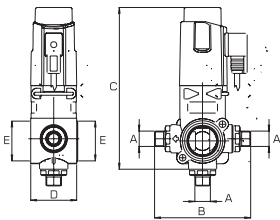

**Standard complete di connettore DIN43650 - B con cavo 1.5 m costampato (IP67) e O Ring 3187 FPM**

**Versioni:** 180.1910.7 - tre vie G1/2M. - completa di nipples  
180.1910.8 - tre vie G3/4M. - completa di nipples

Pressione di esercizio max.: 40 bar

Peso: 1.4 kg

**Materiali:** acciaio inox - materiali plastici ad alta resistenza - FPM - PTFE caricato grafite - ottone con trattamento nichel chimico - ottone - alluminio anticorrosione.

**Impiego:** su atomizzatori, gruppi irroranti e diserbanti. Applicazioni in campo industriale. Valvola a sfera motorizzata con microinterruttori di fine corsa. Tenute in FPM e PTFE caricato grafite. Eccellente affidabilità e durata.

**Standard with 1.5 m moulded cable DIN 43650 - B connector (IP67), O Ring 3187 FKM**

**Models:** 180.1910.7 - three ways 1/2" BSPM. - with nipples  
180.1910.8 - three ways 3/4" BSPM. - with nipples





Max. operating pressure: 40 bar / 580 psi

Weight: 1.4 kg / 3.1 lb

**Materials:** stainless steel - high resistance plastic materials - FKM - graphitized PTFE - Niploy processed brass - brass - corrosion free aluminum.

**Use:** on air blast and boom sprayers. Industrial applications. Electric ball valve with limit stop micro switches. FKM and graphitized PTFE seals. Long life and reliable.

## CARATTERISTICHE TECNICHE / TECHNICAL FEATURES

 bar psi	 l/min-1 bar USG pm-15psi	 12Vdc	A	B mm	C mm	D mm	E	 On/Off	 -10°C - +50°C -14°F - +122°F
40 580	60 16	0.3 - 0.7A	G1/2M. 1/2" BSPM.	110	215	62	G1 1/4F. 1 1/4" BSPF.	1s-1.5s	-10°C - +50°C -14°F - +122°F
40 580	90 24	0.3 - 0.7A	G3/4M. 3/4" BSPM.	130	215	62	G1 1/4F. 1 1/4" BSPF.	1s-1.5s	-10°C - +50°C -14°F - +122°F

## COME SI ORDINA / HOW TO ORDER

**CODICE**  
code

180.1910.7  
180.1910.8

**VERSIONE**  
model

G1/2M - 1/2" BSPM  
G3/4M - 3/4" BSPM

**KIT RICAMBIO**  
spare parts kit

180.302.31  
180.302.31



PAGE 193



PAGE 178 - 179



PAGE 180