

VARIANTE STANDARD / VARIANTE D
STANDARD MODEL / D MODEL

61.1802.47 Ø1.5

VARIANTE STANDARD / STANDARD MODEL
PER TUTTE LE VARIANTI / FOR ALL MODELS

73.602.22
NBR/Buna N

VARIANTI
MODELS

10 / DA - 61.1802.45 Ø1.0

12 / DB - 61.1802.46 Ø1.2

18 / DC - 61.1802.48 Ø1.8

20 / DD - 61.1802.55 Ø2.0

82.617.20
82.617.20 10
82.617.20 12
82.617.20 18
82.617.20 20
82.617.20 D
82.617.20 DA
82.617.20 DB
82.617.20 DC
82.617.20 DD

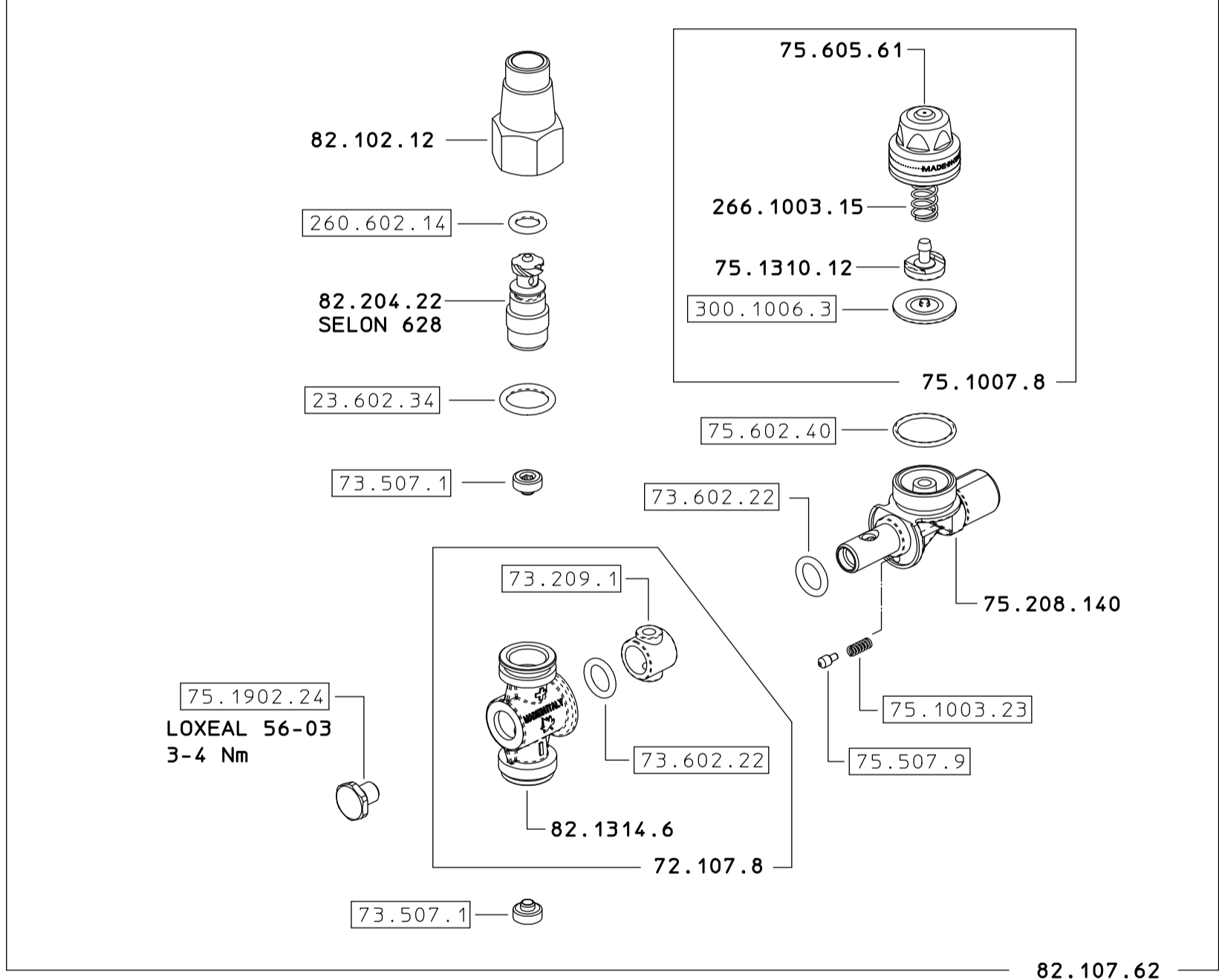

SOLO PER KIT
FOR KIT ONLY

23.602.34

68.602.10

73.602.22 x 2

260.602.14

VARIANTI D DA DB DC DD
D DA DB DC DD MODELS

75.8.3

7.602.13

75.605.97

VARIANTI STANDARD 10 12 18 20
STANDARD MODEL AND 10 12 18 20

75.605.46 Ø15

COME SI ORDINA / HOW TO ORDER
Kit ricambio
Spare parts kit **75.302.28**