

# 87.617.43 87.617.43AT

Variante AT / AT Option

71.605.10

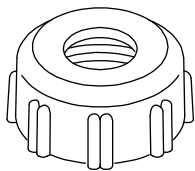

87.1603.35

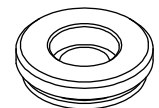

170.602.25

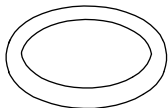

71.203.3

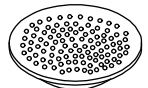

77.810.47

87.810.48

Variante standard / Standard option

71.605.10

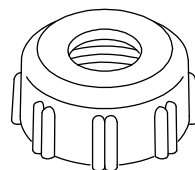

75.605.61

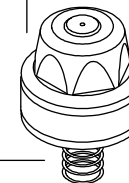

266.1003.15

75.1310.12

300.1006.3

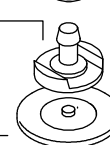

75.1007.8

75.602.40

75.208.132

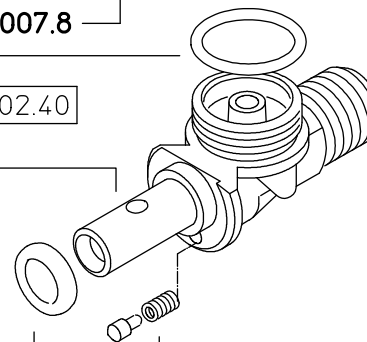

73.507.1



77.208.111

73.209.1

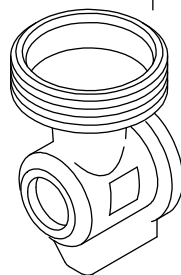

73.602.22

77.107.59

Sigillafilotti

75.1902.24

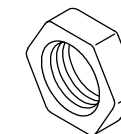

75.301.23

Solo per kit  
Only for kit



23.602.34 x2

68.602.10

73.602.22 x3

260.602.14 x2

73.507.1

Come si ordina/How to order  
Kit ricambio-Cod. **75.302.28**  
Spare parts kit-C/N. **75.302.28**

87.107.170

DENOMINAZIONE: **Getto M87 G3/8 M.**

**Braglia** SRL  
I-42029 Masone (REGGIO EMILIA)-ITALY-UE  
Tel. ++39 0522 340648  
Fax. ++39 0522 345025  
Email [braglia@braglia.it](mailto:braglia@braglia.it)

STE

RTE

N°revisione **03** Data revisione: **01/03/10**

Dis.N°/Codice

**87.617.43**