

Lancia chiusa a tenuta 40 bar  
Spazio minimo residuo per assemblaggio 9.301.7

Shut off spray gun at 40 bar  
Minimum clearance for 9.301.7 assembling

9.1306.1 quota di controllo per tenuta a 40 bar con guarnizioni 9.601.14 conservando la rotazione scorrevole dell'assieme interno

9.1306.1 control dimension for 40 bar seal with 9.601.14 gasket keeping internal assembly smooth rotation

Controlli montaggio / Assembling check - Scala / Scale 1:1

- MAS.901.32
- MAS.901.32 10
- MAS.901.32 12
- MAS.901.32 18
- MAS.901.32 20
- MAS.901.32 23

- 9.801.17  
Ø2.3 VARIANTE / MODEL 23
- 9.801.16  
Ø2.0 VARIANTE / MODEL 20
- 9.801.15  
Ø1.8 VARIANTE / MODEL 18
- 9.801.13  
Ø1.2 VARIANTE / MODEL 12
- 9.801.12  
Ø1.0 VARIANTE / MODEL 10
- 9.801.14  
Ø1.5 VARIANTE STANDARD  
STANDARD MODEL

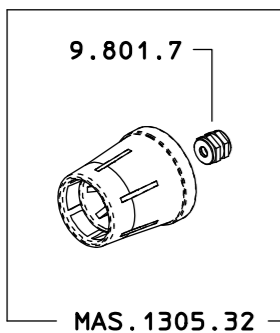
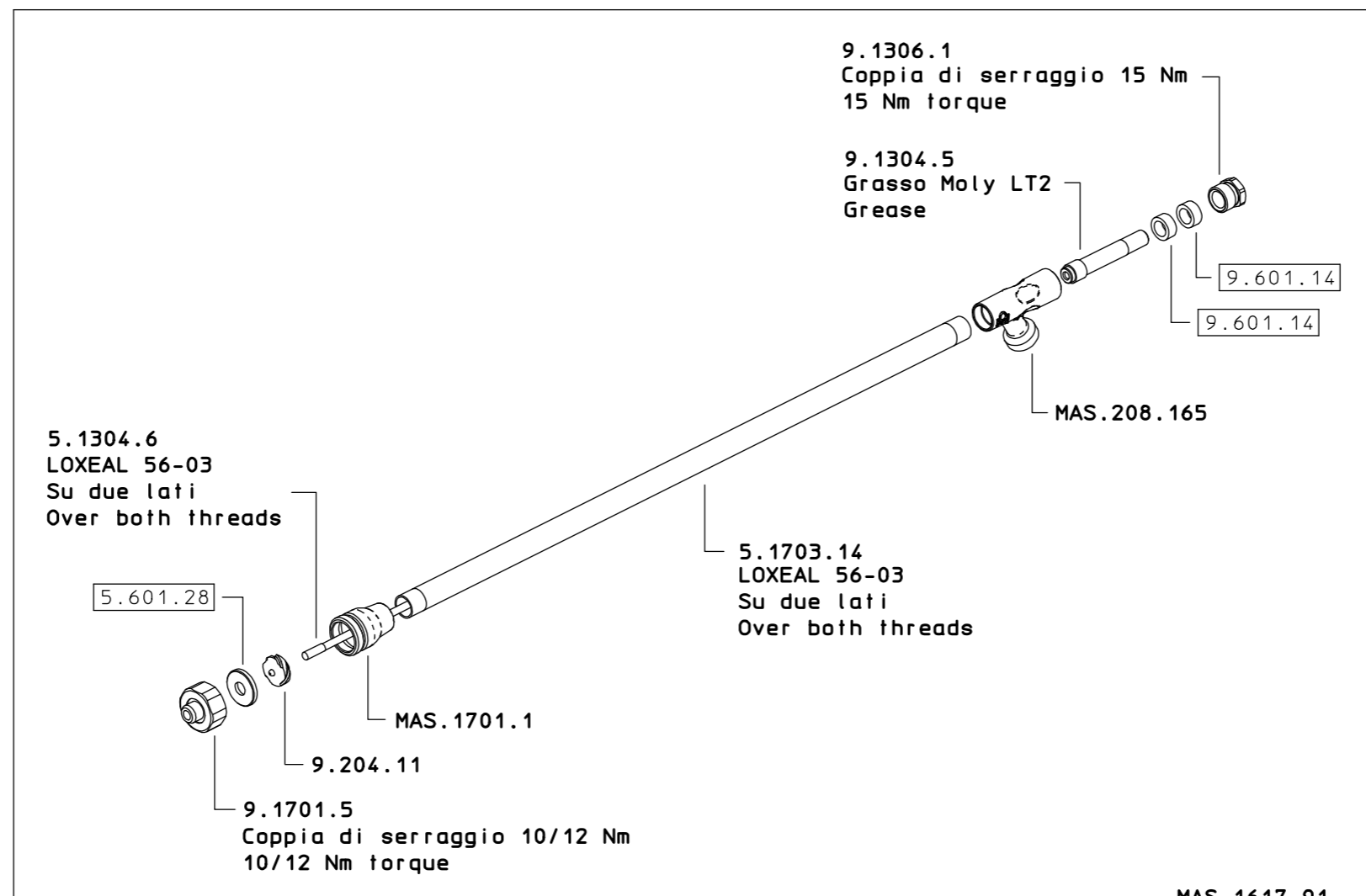

SOLO PER KIT  
FOR KIT ONLY

9.602.21

COME SI ORDINA / HOW TO ORDER  
Kit ricambio  
Spare parts kit **5.302.23.**