

82.617.19
 82.617.19 10
 82.617.19 12
 82.617.19 18
 82.617.19 20
 82.617.19 D
 82.617.19 DA
 82.617.19 DB
 82.617.19 DC
 82.617.19 DD
 82.617.19 SU

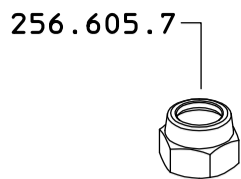

VARIANTE STANDARD / VARIANTE D
 STANDARD MODEL / D MODEL
 61.1802.47 Ø1.5

VARIANTE 82.617.19 SU
 - SENZA UGELLO 61.1802.47
 - SENZA OR 73.602.22
 82.617.19 SU MODEL
 - WITHOUT 61.1802.47 SPRAY TIP
 - WITHOUT 73.602.22 ORING

VARIANTI STANDARD 10 12 18 20 D DA DB DC DD
 STANDARD 10 12 18 20 D DA DB DC DD MODELS
 73.602.22
 NBR/Buna N

VARIANTI MODELS
 10 / DA - 61.1802.45 Ø1.0
 12 / DB - 61.1802.46 Ø1.2
 18 / DC - 61.1802.48 Ø1.8
 20 / DD - 61.1802.55 Ø2.0

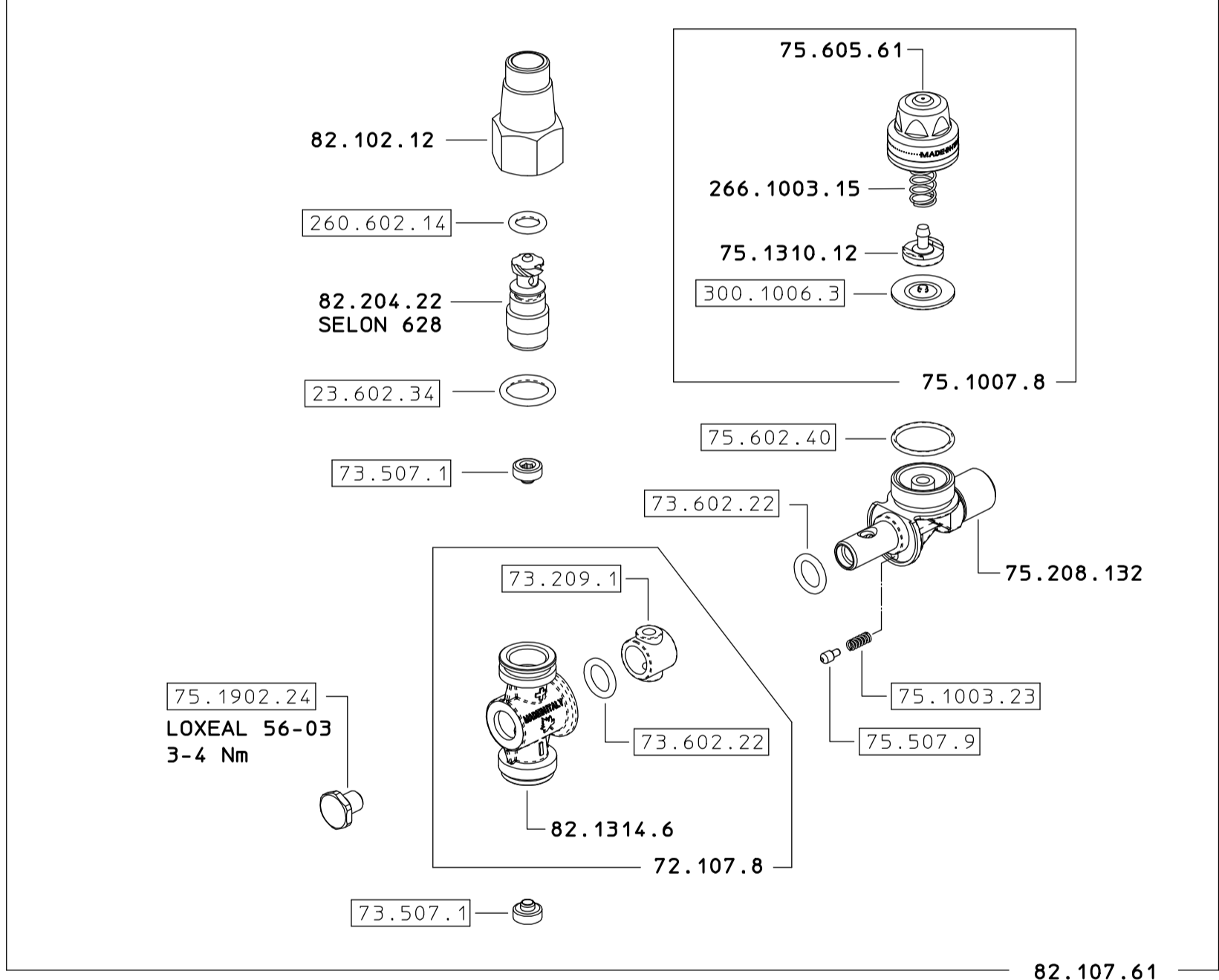

75.301.23
 SOLO PER KIT
 FOR KIT ONLY
 23.602.34
 68.602.10
 73.602.22 x 2
 260.602.14

82.107.61

VARIANTI D DA DB DC DD
 D DA DB DC DD MODELS
 75.8.3
 7.602.13
 75.605.97

VARIANTI STANDARD 10 12 18 20 SU
 STANDARD MODEL AND 10 12 18 20 SU
 75.605.46 Ø15

COME SI ORDINA / HOW TO ORDER
 Kit ricambio
 Spare parts kit **75.302.28**