

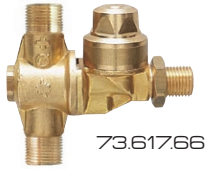

M73 ANTIGOCCIA M73 ANTIDRIP

POSIZIONAMENTO
E TENUTA SENZA COLLANTI
ADJUST NOZZLE POSITION
AND SEAL WITHOUT BONDING



73.617.66



G1/4M.-1/4" BSPM
Dado con O Ring
Nut with O Ring

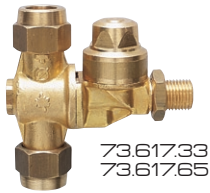

73.617.33
73.617.65



73.617.45



256.605.7
G3/8 3/8" BSPF



716.605.3
G3/8 3/8" BSPF AD/AC



73.605.68
11/16-16 UN



73.617.38
73.617.39

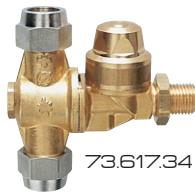

73.617.34



73.605.27
G3/8 3/8" BSPF
73.605.28
11/16-16 UN

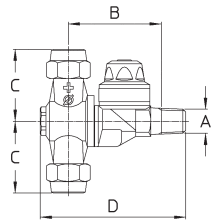
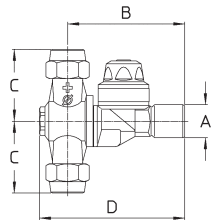
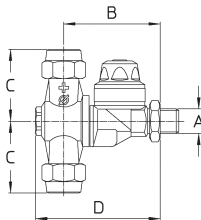

Standard completo di ghiera - ugelli non compresi - opzioni con filtro
Versione 73.617.66 con tenute in FPM, fornito senza ghiera.

Pressione di esercizio max.: 40 bar
Peso: G1/4M. 260 g - 1/4"NPTM. 260 g - G1/4F. 260 g - 1/4"NPTF. 260 g

Materiali: ottone - acciaio inox - NBR - FPM - PVC

Impiego: su atomizzatori. Due ugelli selezionabili con posizioni intermedie di chiusura. Due posizioni "APERTO" inclinate $\pm 15^\circ$ dalla verticale. Ogni posizione è segnalata da uno scatto. Antigoccia resistente ed efficace a bassa e ad alta pressione.

Standard with caps - spray tips not included - strainer options
73.617.66 model with FKM seal, caps not included.

Max. operating pressure: 40 bar / 600 psi
Weight: 1/4" BSPM. 260 g / 9.2 oz. - 1/4" NPTM. 260 g / 9.2 oz. - 1/4" BSPF. 260 g / 9.2 oz. - 1/4" NPTF. 260 g / 9.2 oz

Materials: brass - stainless steel - Buna N - FKM - PVC

Use: on air blast sprayers. Rollover to select spray tips with two shut off positions. Two "OPEN" positions at $\pm 15^\circ$ from vertical. A click point out each position. Check valve assures efficient and long lasting operations at low and high pressures.



COME SI ORDINA / HOW TO ORDER

CODICE code	GHIERA cap	PER UGELLI for spray tips	FILTRO strainer	A	B mm	C mm	D mm		KIT RICAMBIO spare parts kit
73.617.33	11/16 16UN-Ch21	Ø 15 KIT disc+core	X	G1/4M. 1/4" BSPM	51	40	66	10	75.302.28
73.617.33 A	11/16 16UN-Ch21	Ø 15 KIT disc+core	-						
73.617.33 B	11/16 16UN ALETTATA WINGED	Ø 15 KIT disc+core	-						
73.617.33 C	1/16 16UN ALETTATA WINGED	Ø 15 KIT disc+core	X						
73.617.33 E	11/16 16UN-Ch21 11/16 16UN ALETTATA WINGED	Ø 15 KIT disc+core	X						
73.617.66	-	Ø 15 KIT disc+core	-	G1/4M. 1/4" BSPM	51	35	66	10	75.302.28
73.617.65	11/16 16UN-Ch21	Ø 15 KIT disc+core	X	G3/8M.-G1/8F. 3/8" BSPM. 1/8" BSPF.	51	40	66	10	75.302.28
73.617.65 A	11/16 16UN-Ch21	Ø 15 KIT disc+core	-						
73.617.65 B	11/16 16UN ALETTATA WINGED	Ø 15 KIT disc+core	-						
73.617.65 C	1/16 16UN ALETTATA WINGED	Ø 15 KIT disc+core	X						
73.617.38	11/16 16UN-Ch21	Ø 15 KIT disc+core	X	G1/4F. 1/4" BSPF.	62	40	77	10	75.302.28
73.617.38 A	11/16 16UN-Ch21	Ø 15 KIT disc+core	-						
73.617.38 B	11/16 16UN ALETTATA WINGED	Ø 15 KIT disc+core	-						
73.617.38 C	1/16 16UN ALETTATA WINGED	Ø 15 KIT disc+core	X						
73.617.39	11/16 16UN-Ch21	Ø 15 KIT disc+core	X	1/4NPTF.	51	40	66	10	75.302.28
73.617.39 A	11/16 16UN-Ch21	Ø 15 KIT disc+core	-						
73.617.39 B	11/16 16UN ALETTATA WINGED	Ø 15 KIT disc+core	-						
73.617.39 C	1/16 16UN ALETTATA WINGED	Ø 15 KIT disc+core	X						
73.617.45	11/16 16UN-Ch21	Ø 15 KIT disc+core	X	1/4NPTM.	51	40	66	50	75.302.28
73.617.34	G3/8 M-Ch20	Ø 15 KIT	X	G1/4M. 1/4" BSPM	62	40	77	10	75.302.28
73.617.34 A	G3/8 M-Ch20	Ø 15 KIT	-						
73.617.34 B	G3/8 M. ALETTATA 3/8" BSPM. WINGED	Ø 15 KIT	-						
73.617.34 C	G3/8 M. ALETTATA 3/8" BSPM. WINGED	Ø 15 KIT	X						
73.617.34 D	G3/8 M-Ch20 716.605.3	AD/AC	X	G1/4M. 1/4" BSPM	62	40	77	10	75.302.28

FRMJKM



UGELLI
TIPS