

# 10. 901.74

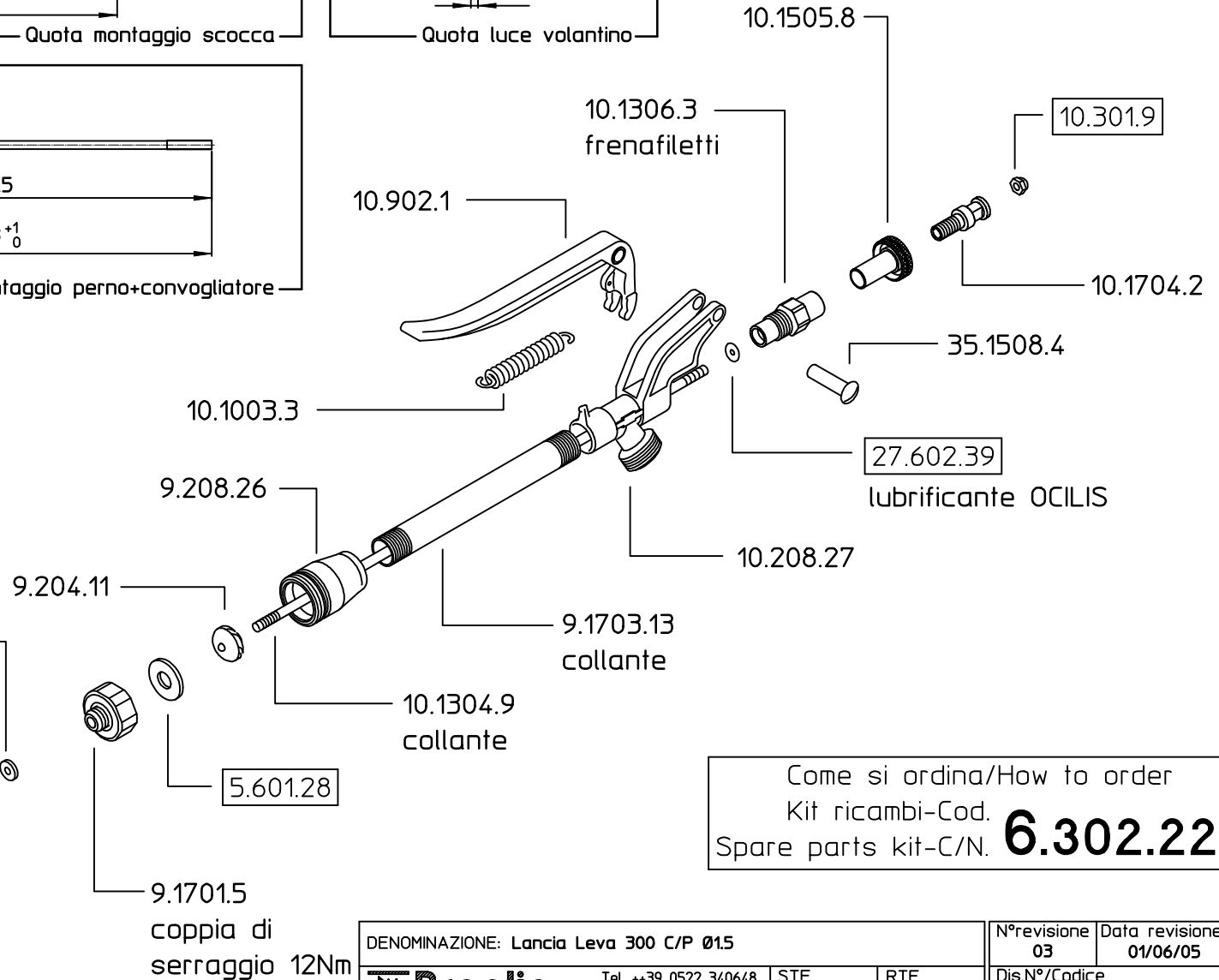
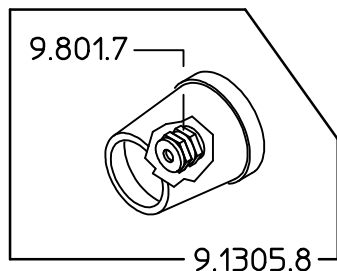
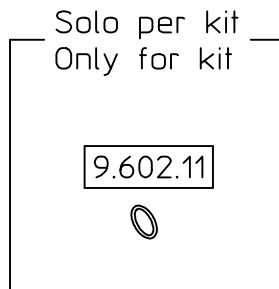
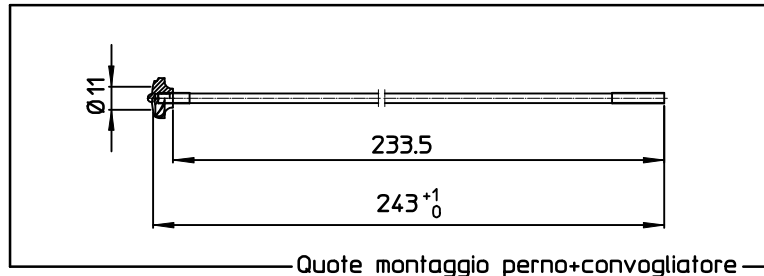
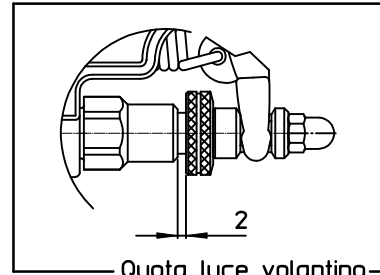
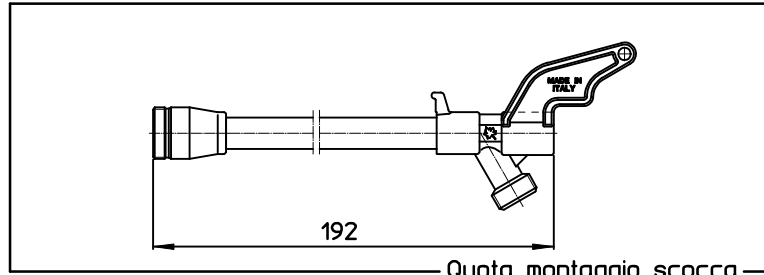

Come si ordina/How to order  
Kit ricambi-Cod. **6.302.22**  
Spare parts kit-C/N.

DENOMINAZIONE: Lancia Leva 300 C/P Ø15				N°revisione 03	Data revisione: 01/06/05
		Tel. ++39 0522 340648	STE	RTE	Dis.N°/Codice 10.901.74
I-42029 Masone (REGGIO EMILIA)-ITALY-UE		Fax. ++39 0522 345025	Email braglia@braglia.it		