

# 83.1007.15

83.1904.3

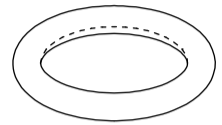

83.602.81

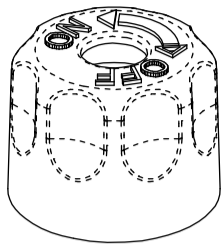
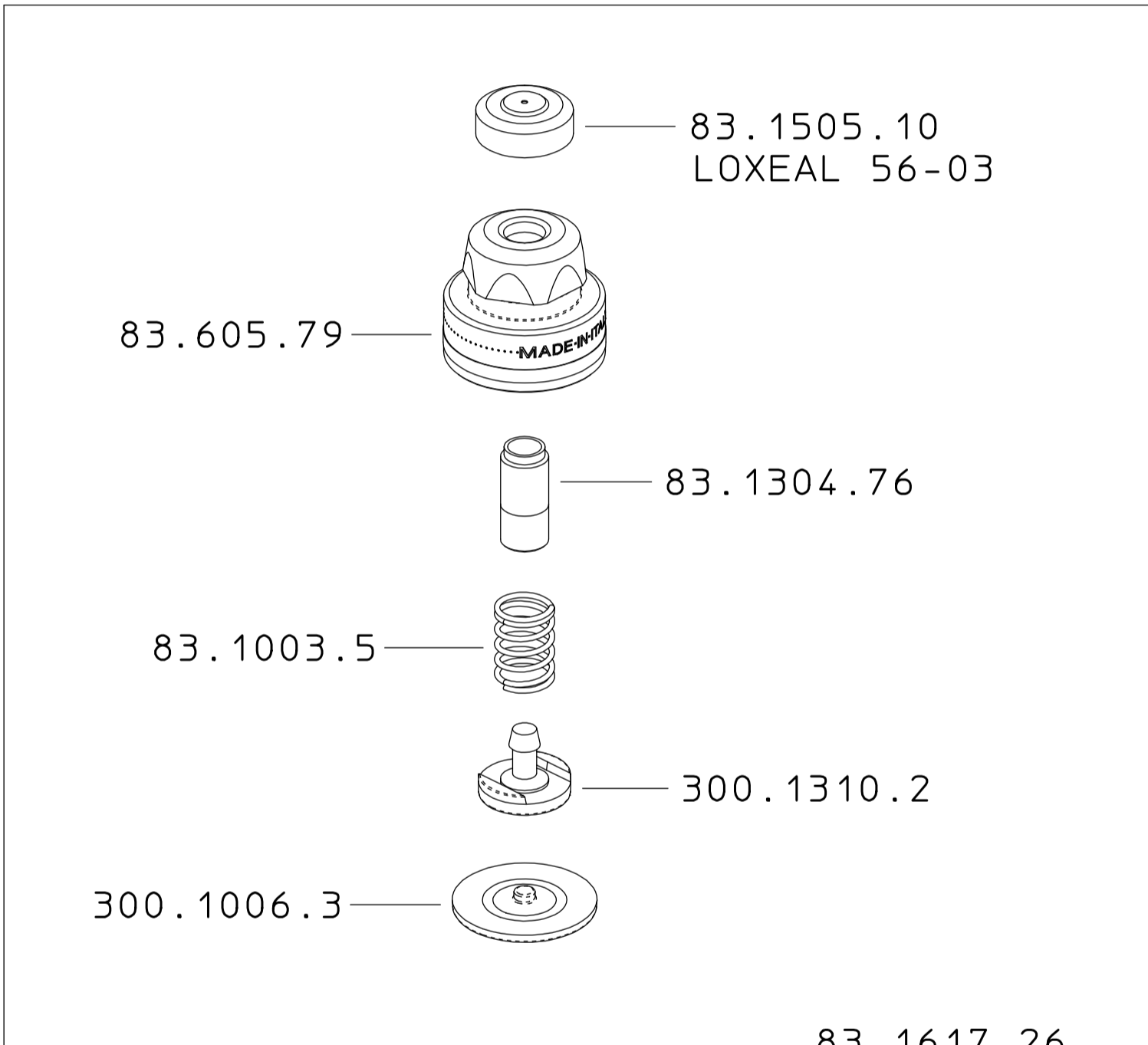

83.1505.10  
LOXEAL 56-03

83.605.79

83.1304.76

83.1003.5

300.1310.2

300.1006.3

83.1617.26

Lubrificare con Moly LT2  
M8x1 del 83.1304.76

75.602.40

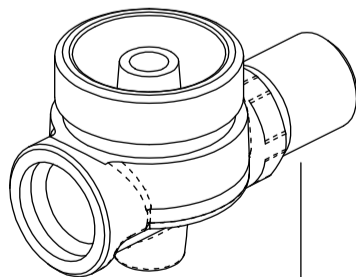
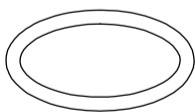

83.208.150

DESCRIZIONE: MODULO M83 G1/4M. G1/4F. CON VOLANTINO

N°revisione  
04

Data revisione  
23/04/2014



**Braglia** SRL

Tel. +39 0522 340648

Fax. +39 0522 345025

I-42122 REGGIO EMILIA - ITALY - UE Email tecnico@braglia.it

DISEGNATO

G.BRAGLIA

APPROVATO

G.BRAGLIA

Dis.N°/Codice

83.1007.15