

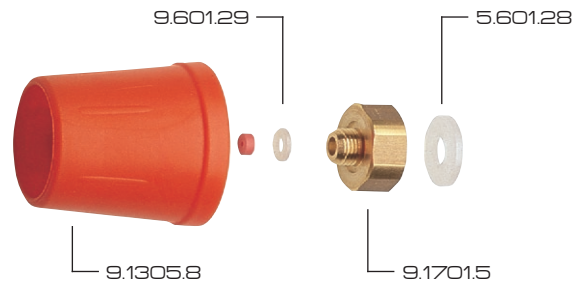

PROTEZIONE "TURBO" "TURBO" PROTECTION



PROTEZIONE COMPLETA
complete protection

FORO mm	PRESTAZIONI	PRESSIONE					
		15 bar		30 bar		50 bar	
		cono	spillo	cono	spillo	cono	spillo
Ø 1.0	portata l/min	1.8	2.3	2.6	3.2	3.4	4.1
	angolo di spruzzo	30°	-	35°	-	40°	-
	gittata max. m.	2.1	5.0	2.4	5.6	2.8	6.3
Ø 1.2	portata l/min	2.4	3.0	3.4	4.2	4.4	5.4
	angolo di spruzzo	35°	-	40°	-	45°	-
	gittata max. m.	2.3	5.8	2.7	6.1	3.1	6.8
Ø 1.5	portata l/min	3.4	4.5	4.8	6.4	6.2	8.3
	angolo di spruzzo	40°	-	45°	-	50°	-
	gittata max. m.	2.6	6.6	3.0	7.0	3.5	7.7
Ø 1.8	portata l/min	3.9	6.9	5.5	9.8	7.1	12.7
	angolo di spruzzo	50°	-	55°	-	60°	-
	gittata max. m.	2.9	7.0	3.3	7.5	4.0	8.3
Ø 2.0	portata l/min	4.5	8.3	6.3	11.7	8.1	15.1
	angolo di spruzzo	55°	-	60°	-	65°	-
	gittata max. m.	3.1	7.5	3.5	8.0	4.5	8.9
Ø 2.3	portata l/min	5.3	11.4	7.5	16.1	9.7	20.8
	angolo di spruzzo	60°	-	65°	-	75°	-
	gittata max. m.	3.4	8.0	4.0	8.5	4.8	9.3

HOLE DIA. mm	PERFORMANCES	PRESSURE					
		200 psi		450 psi		700 psi	
		cone	straight	cone	straight	cone	straight
Ø 1.0	capacity US/GPM	0.44	0.56	0.71	0.87	0.87	1.05
	spray angle	30°	-	35°	-	40°	-
	max. throw ft.	6.3	15.1	8.1	19.0	8.9	20.0
Ø 1.2	capacity US/GPM	0.58	0.73	0.93	1.15	1.12	1.38
	spray angle	35°	-	40°	-	45°	-
	max. throw ft.	6.9	17.5	9.2	20.7	9.8	21.5
Ø 1.5	capacity US/GPM	0.83	1.10	1.31	1.78	1.59	2.12
	spray angle	40°	-	45°	-	50°	-
	max. throw ft.	7.8	20.0	10.2	23.8	11.1	24.4
Ø 1.8	capacity US/GPM	0.95	1.68	1.50	2.68	1.81	3.24
	spray angle	50°	-	55°	-	60°	-
	max. throw ft.	8.7	21.2	11.2	25.5	12.6	26.3
Ø 2.0	capacity US/GPM	1.10	2.02	1.72	3.20	2.07	3.85
	spray angle	55°	-	60°	-	65°	-
	max. throw ft.	9.4	22.6	11.9	27.2	14.3	28.2
Ø 2.3	capacity US/GPM	1.29	2.77	2.05	4.40	2.47	5.31
	spray angle	60°	-	65°	-	75°	-
	max. throw ft.	10.3	24.1	13.6	28.9	15.3	29.5

COME SI ORDINA / HOW TO ORDER

PROTEZIONE COMPLETA complete protection	Ø	SOLO PROTEZIONE protection only	SOLO UGELLO spray tip only	Ø	SOLO GUARNIZIONE gasket only
9.1312.2	1.0	9.1305.8	9.801.12	1.0	9.601.29
9.1312.3	1.2		9.801.13	1.2	
9.1312.1	1.5		9.801.14	1.5	
9.1312.4	1.8		9.801.15	1.8	
9.1312.5	2.0		9.801.16	2.0	
9.1312.6	2.3		9.801.17	2.3	