

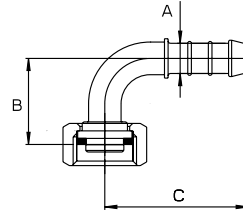

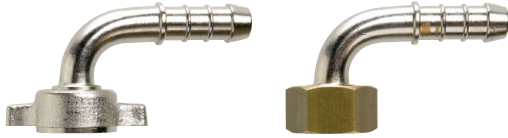

GIUNTO 90° / 90° HOSE SHANK



Materiali: ottone nichelato - ottone
Attacco: G1/2F.

Materials: nickel plated brass - brass
Connection: 1/2" BSPF.

COME SI ORDINA / HOW TO ORDER

CODICE code	Ø mm.	GHIERA nut	SOLO RACCORDO shank only	SOLO GHIERA nut only	SOLO GUARNIZIONE gasket only	A mm	B mm	C mm	
163.604.26	8	GIRELLO - fly nut	163.1502.18	162.605.2	162.601.6	8	32	51	25
163.604.27	8	CH 24 - hex. 24	163.1502.18	162.605.21		8	32	51	25
163.604.25	9.4	GIRELLO - fly nut	163.1502.15	162.605.2		9.4	30	52	1000
163.604.22	9.4	CH 24 - hex. 24	163.1502.15	162.605.21		9.4	30	52	1000
163.604.4	10	GIRELLO - fly nut	163.1502.12	162.605.2		10	30	52	25
163.604.12	10	CH 24 - hex. 24	163.1502.12	162.605.21		10	30	52	25
163.604.6	13	GIRELLO - fly nut	163.1502.14	162.605.2		13	32	54	25
163.604.13	13	CH 24 - hex. 24	163.1502.14	162.605.21		13	32	54	25

GIUNTO DOPPIO / DOUBLE HOSE SHANK



Materiali: ottone
Attacco: G1/2F. - 162.604.9 G3/4F.

Materials: brass
Connection: 1/2" BSPF. - 162.604.9 3/4" BSPF.

COME SI ORDINA / HOW TO ORDER

CODICE code	Ø mm.	GHIERA nut	SOLO RACCORDO shank only	SOLO GHIERA nut only	SOLO GUARNIZIONE gasket only	
162.604.7	10	GIRELLO - fly nut	162.1502.20	162.605.2	162.601.6	25
162.604.10	10	CH 24 - hex. 24	162.1502.20	162.605.21	162.601.6	25
162.604.8	13	GIRELLO - fly nut	162.1502.21	162.605.2	162.601.6	25
162.604.11	13	CH 24 - hex. 24	162.1502.21	162.605.21	162.601.6	25
162.604.9	19	CH 30 - hex. 30	162.1502.22	162.605.22	23.602.34	25